

VICINITY MAP
SCALE: 1" = 2000'



GALVESTON PEDESTRIAN IMPROVEMENTS

NOVEMBER, 2025
1TGCI
CITY OF BEND, DESCHUTES COUNTY, OREGON

50% PLAN REVIEW SET

OWNER:
CITY OF BEND
710 NW WALL ST
BEND, OR 97701
541-330-4000

PRELIMINARY NOT
FOR CONSTRUCTION

GALVESTON PEDESTRIAN IMPROVEMENTS
CITY PROJECT #1TGCI
COVER SHEET
DESCHUTES COUNTY, OREGON



ENGINEERING

REVISIONS:

CITY OF BEND
ENGINEERING
710 NW WALL ST
BEND, OR 97701
541-330-4000

DESIGNED BY: DSE
DRAWN BY: DSE
SCALE: PER PLANS
FILE:
DATE: 11/04/2025

VERIFY SCALES
0 1"
BAR EQUALS ONE INCH
ON ORIGINAL DRAWING

SHEET:

G1.0

COB # 1TGCI

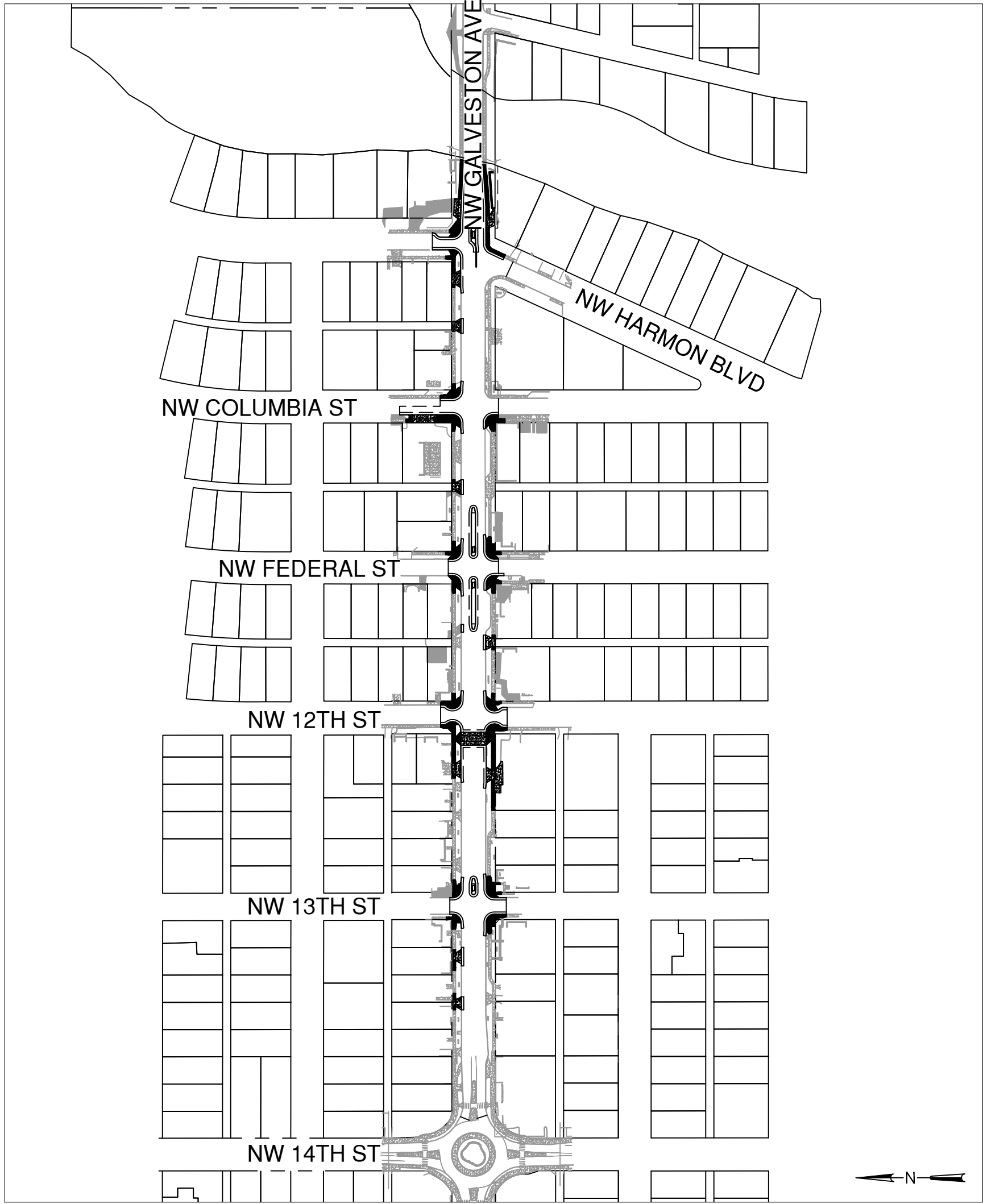

SITE PLAN
SCALE: 1"=200'

LEGEND:

*FADED BLACK FEATURES ARE EXISTING (EXCEPT FOR FOUND MONUMENTS)

- PROPERTY / ROW
- EASEMENT
- PROPERTY SETBACKS
- CENTERLINE
- SS SANITARY SEWER
- SS FORCE MAIN
- W WATER
- SD STORM DRAIN
- G GAS
- CATV CABLE TV
- FO FIBER OPTICS
- IRR IRRIGATION
- E POWER
- OHU POWER (OVERHEAD)
- DITCH (CENTER)
- FENCE (OTHER)
- FENCE (SILT)
- FENCE (STEEL)
- FENCE (WOOD)
- RAILROAD

- BENCHMARK (FOUND)
- BENCHMARK (SET)
- MONUMENT (FOUND)
- MONUMENT (SET)
- CONTROL MONUMENT

- CONIFEROUS TREE
- DECIDUOUS TREE

- MAILBOX
- GRAVEL
- SIDEWALK
- SIGN
- CLEANOUT
- SANITARY MANHOLE
- CATCH BASIN
- CULVERT
- DITCH INLET
- DRYWELL
- STORM MANHOLE

- WATER AIR RELEASE VALVE
- WATER BELL JOINT
- WATER BLIND FLANGE
- WATER BLOW OFF VALVE
- WATER BUTTERFLY VALVE
- WATER CHECK VALVE
- WATER COMBINATION AIR RELEASE VALVE
- WATER DOUBLE DETECTOR CHECK VALVE
- WATER FIRE DEPT CONNECTION
- WATER FIRE HYDRANT
- WATER FLANGED GATE VALVE
- WATER FLANGED BY MECHANICAL JOINT GATE VALVE
- WATER GATE VALVE
- WATER MECHANICAL JOINT
- WATER METER
- WATER PRESSURE REDUCING VALVE
- WATER PRESSURE REGULATOR/SUSTAINING
- WATER PRESSURE RELIEF VALVE
- WATER RESTRAINED MECHANICAL JOINT
- WATER SAMPLE STATION
- WATER SINGLE DETECTOR CHECK VALVE
- WATER THRUST BLOCK (STRADDLE)
- WATER THRUST BLOCK
- GAS METER
- GAS VALVE
- TELEPHONE RISER
- TELEPHONE MANHOLE
- TRAFFIC CONTROL BOX
- UTILITY POLE
- UTILITY POLE/LIGHT
- GUY WIRE

APPROVALS:

CITY OF BEND ENGINEER: _____

NOTE: SIGNATURE DOES NOT GRANT APPROVAL TO COMMENCE CONSTRUCTION.

SHEET INDEX	
SHEET NUMBER	SHEET TITLE
G1.0	COVER SHEET
G1.1	GENERAL NOTES
G2.0	OVERALL SITE AND KEY PLAN
C0.1	EXISTING CONDITIONS AND ECS PLAN
C1.0	DEMOLITION PLAN
C2.0	ROADWAY PLAN
C2.1	ROADWAY PLAN
C2.2	ROADWAY PLAN
C2.4	ROADWAY PLAN
C2.3	ROADWAY PLAN
C2.5	ROADWAY PLAN
C2.6	ROADWAY PLAN
C2.7	ROADWAY PLAN
C3.0	GRADING DETAILS
C3.1	GRADING DETAILS
C3.2	GRADING DETAILS
C3.3	GRADING DETAILS
C3.4	GRADING DETAILS
C3.5	GRADING DETAILS
C3.6	GRADING DETAILS
C3.7	GRADING DETAILS
C3.8	GRADING DETAILS
C3.9	GRADING DETAILS
C3.10	GRADING DETAILS
C3.11	GRADING DETAILS
C3.12	GRADING DETAILS
C3.13	GRADING DETAILS
C3.14	GRADING DETAILS
C3.15	GRADING DETAILS
C3.16	GRADING DETAILS
C3.17	GRADING DETAILS
C3.18	GRADING DETAILS
C3.19	GRADING DETAILS
C3.20	GRADING DETAILS
C3.21	GRADING DETAILS
C3.22	GRADING DETAILS
C4.0	GRADING DETAILS
C5.0	STANDARD COB DETAILS
C5.1	STANDARD COB DETAILS
C5.2	STANDARD COB DETAILS
C5.3	STANDARD COB DETAILS

Plotted: 11/4/25 at 2:00pm By: delmore

	1	2	3	4	5	6																																													
A	<div>ABBREVIATIONS</div> <table><tr><td>AVE</td><td>AVENUE</td></tr><tr><td>CL</td><td>CENTERLINE</td></tr><tr><td>COMM</td><td>COMMUNICATIONS</td></tr><tr><td>E</td><td>EAST / EASTING</td></tr><tr><td>ELEV</td><td>ELEVATION</td></tr><tr><td>EX</td><td>EXISTING</td></tr><tr><td>FFE</td><td>FINISHED FLOOR ELEVATION</td></tr><tr><td>IE</td><td>INVERT ELEVATION</td></tr><tr><td>L</td><td>LENGTH</td></tr><tr><td>LT</td><td>LEFT</td></tr><tr><td>LF</td><td>LINEAL FEET</td></tr><tr><td>MH</td><td>MANHOLE</td></tr><tr><td>N</td><td>NORTH / NORTHING</td></tr><tr><td>NTS</td><td>NOT TO SCALE</td></tr><tr><td>RT</td><td>RIGHT</td></tr><tr><td>S</td><td>SOUTH</td></tr><tr><td>SS</td><td>SANITARY SEWER</td></tr><tr><td>ST</td><td>STREET</td></tr><tr><td>STA</td><td>STATION</td></tr><tr><td>SY</td><td>SQUARE YARDS</td></tr><tr><td>TYP</td><td>TYPICAL</td></tr><tr><td>W</td><td>WEST</td></tr></table>						AVE	AVENUE	CL	CENTERLINE	COMM	COMMUNICATIONS	E	EAST / EASTING	ELEV	ELEVATION	EX	EXISTING	FFE	FINISHED FLOOR ELEVATION	IE	INVERT ELEVATION	L	LENGTH	LT	LEFT	LF	LINEAL FEET	MH	MANHOLE	N	NORTH / NORTHING	NTS	NOT TO SCALE	RT	RIGHT	S	SOUTH	SS	SANITARY SEWER	ST	STREET	STA	STATION	SY	SQUARE YARDS	TYP	TYPICAL	W	WEST	
AVE	AVENUE																																																		
CL	CENTERLINE																																																		
COMM	COMMUNICATIONS																																																		
E	EAST / EASTING																																																		
ELEV	ELEVATION																																																		
EX	EXISTING																																																		
FFE	FINISHED FLOOR ELEVATION																																																		
IE	INVERT ELEVATION																																																		
L	LENGTH																																																		
LT	LEFT																																																		
LF	LINEAL FEET																																																		
MH	MANHOLE																																																		
N	NORTH / NORTHING																																																		
NTS	NOT TO SCALE																																																		
RT	RIGHT																																																		
S	SOUTH																																																		
SS	SANITARY SEWER																																																		
ST	STREET																																																		
STA	STATION																																																		
SY	SQUARE YARDS																																																		
TYP	TYPICAL																																																		
W	WEST																																																		
B	<div>GENERAL NOTES</div> <ol style="list-style-type: none">CONTRACTOR SHALL VERIFY ALL CONDITIONS ON THE JOB SITE INCLUDING BUT NOT LIMITED TO, ALL DIMENSIONS, GRADES, ELEVATIONS, EXTENT AND COMPATIBILITY TO THE EXISTING SITE CONDITIONS, AND WITH THE WORK DESCRIBED ON THE ENGINEER'S DRAWINGS. ANY DISCREPANCIES OR UNEXPECTED CONDITIONS THAT AFFECT OR CHANGE THE WORK DESCRIBED IN THE CONTRACT DOCUMENTS SHALL BE BROUGHT TO THE ENGINEER'S ATTENTION IMMEDIATELY. CONTRACTOR SHALL NOT PROCEED WITH ANY OF THE WORK IN THE AREA OF DISCREPANCIES UNTIL ALL SUCH DISCREPANCIES ARE RESOLVED. IF THE CONTRACTOR CHOOSES TO PERFORM WORK, THEN IT IS UNDERSTOOD THAT THE CONTRACTOR IS CHOOSING TO PROCEED AT THE CONTRACTOR'S OWN RISK AND SHALL INCUR ALL COSTS, IF ANY, TO RESOLVE THE ISSUES TO THE SATISFACTION OF THE ENGINEER.IT SHALL BE THE RESPONSIBILITY OF THE CONTRACTOR TO CONTACT "UNDERGROUND LOCATE SERVICE" AT 1-800-332-2344 AT LEAST 48 BUSINESS-DAY HOURS PRIOR TO THE START OF CONSTRUCTION FOR THE LOCATION OF ALL UTILITIES, INCLUDING BUT NOT LIMITED TO POWER, WATER, SEWER, STORMWATER, GAS, CABLE TV AND TELEPHONE UNDERGROUND FACILITIES. THE CONTRACTOR WILL ALSO BE RESPONSIBLE FOR CONTACTING THE APPROPRIATE PUBLIC AGENCY FOR THE LOCATION OF UNDERGROUND FACILITIES.ALL UTILITIES SHOWN ARE ACCURATE TO THE EXTENT OF AVAILABLE RECORDS AND KNOWLEDGE. THE CONTRACTOR HAS THE TOTAL RESPONSIBILITY TO VERIFY THE LOCATION OF EXISTING UNDERGROUND UTILITIES AND TO NOTIFY THE UTILITY COMPANIES WHEN WORKING IN THEIR PROXIMITY. CONTRACTOR TO VERIFY LOCATION OF EXISTING UTILITIES PRIOR TO CONSTRUCTION. OREGON LAW REQUIRES THE CONTRACTOR TO FOLLOW RULES ADOPTED BY THE OREGON UTILITY NOTIFICATION CENTER. THOSE RULES ARE SET FORTH IN OAR 952-001-0010 THROUGH 952-001-0090. THE CONTRACTOR MAY OBTAIN COPIES OF THE RULES BY CALLING THE OREGON UTILITY NOTIFICATION CENTER AT (503)232-2987.ALL UNSUITABLE SOILS MATERIALS, RUBBISH AND DEBRIS RESULTING FROM GRADING OPERATIONS SHALL BE REMOVED FROM THE JOB SITE AND DISPOSED OF PROPERLY.THE CONTRACTOR SHALL EMPLOY ALL LABOR, EQUIPMENT, AND METHODS REQUIRED TO PREVENT DUST AND EROSION IN AMOUNTS DAMAGING TO PROPERTY, CULTIVATED VEGETATION AND DOMESTIC ANIMALS OR CAUSING A NUISANCE TO PERSONS OCCUPYING BUILDINGS IN THE VICINITY OF THE JOB SITE. THE CONTRACTOR SHALL BE RESPONSIBLE FOR ANY DAMAGE CAUSED BY DUST AND EROSION RESULTING FROM CONSTRUCTION.THE CONTRACTOR SHALL FOLLOW ALL APPLICABLE INDUSTRIAL SAFETY REGULATIONS. THE CITY AND DESCHUTES COUNTY AND THEIR OFFICIALS, THE EOR, AND THE OWNER ARE NOT BE RESPONSIBLE FOR ENFORCING SAFETY REGULATIONS.ALL WORK IN THE PUBLIC RIGHT OF WAY SHALL BE PERFORMED BY A CITY APPROVED QUALIFIED CONTRACTOR (INCLUDING SUBCONTRACTORS).ALL WATER MAIN CONNECTIONS TO BE DESIGNED AND CONSTRUCTED WITH CROSS CONNECTION PROTECTION.ALL RESTORATION TO BE COMPLETED AS SOON AS POSSIBLE UPON COMPLETION AND APPROVAL FROM THE CITY OF BEND FOR ON-SITE WORK AND UNDERGROUND WORK. ALL RESTORATION SHALL COMPLY WITH CITY OF BEND STANDARDS AND SPECIFICATIONS.WORK HOURS SHALL BE LIMITED TO 7:00 AM TO 6:30 PM AND SHALL COMPLY WITH THE NOISE LIMITATIONS PER CITY OF BEND MUNICIPAL CODE 5.50. WORK OUTSIDE OF THESE HOURS SHALL REQUIRE A NOISE AND NIGHT WORK PERMIT SUBJECT TO THE REVIEW AND APPROVAL OF THE ASSISTANT CITY ENGINEER.																																																		
C	<div>STREET NOTES</div> <ol style="list-style-type: none">ANY WORK WITHIN THE PUBLIC RIGHT-OF-WAY THAT DISTURBS A PEDESTRIAN SIDEWALK, PATH, OR TRAIL REQUIRES THE REPLACEMENT OF THAT FACILITY TO CURRENT CITY AND PUBLIC RIGHT-OF-WAY ACCESSIBILITY GUIDELINES (PROWAG) STANDARDS. THIS INCLUDES BUT IS NOT LIMITED TO ALL ADA RAMPS, CONCRETE SIDEWALKS/PATHS, ASPHALT TRAILS, DRIVEPADS, CROSSWALKS, AND SIGNAGE.																																																		
D	<div>UTILITY NOTES</div> <ol style="list-style-type: none">UTILITY CROSSINGS SHALL MAINTAIN A MINIMUM VERTICAL SEPARATION OF 12 INCHES FROM ALL WATER AND SEWER MAIN LINES.ANY UTILITY THAT IS LOCATED PARALLEL TO A CITY WATER OR SEWER MAIN LINE SHALL MAINTAIN A MINIMUM OF 10-FT OF HORIZONTAL SEPARATION.UTILITY CROSSINGS SHALL MAINTAIN 2 FT CLEARANCE HORIZONTALLY FROM CITY UTILITIES SUCH AS MANHOLES, VALVE CANS, INLETS, CATCH BASINS, ETC.COMPACTION AND COMPACTION TESTING IS REQUIRED PER SECTION 00405.46 (C) OR AT THE DISCRETION OF THE CITY ENGINEER. ALL LIFTS MUST BE MECHANICALLY COMPACTED WITH ADEQUATE COMPACTION EQUIPMENT, WITH A MINIMUM OF 5 PASSES FOR EACH LIFT OR AS DIRECTED BY THE CITY.																																																		
	<div>TRAFFIC CONTROL NOTES</div> <ol style="list-style-type: none">THE CONTRACTOR IS RESPONSIBLE FOR IMPLEMENTING THE APPROVED TRAFFIC CONTROL PLAN (TCP) TO PROVIDE SAFE AND EFFICIENT VEHICULAR, BICYCLE AND PEDESTRIAN MOVEMENT IN AND AROUND THE WORK ZONES. CERTIFIED TRAFFIC CONTROL FLAGGERS AND PROFESSIONALS MAY BE REQUIRED. THE CITY OF BEND RESERVES THE RIGHT TO MODIFY THE TCP AT ANY TIME BASED ON FIELD CONDITIONS.CONTRACTOR SHALL NOT STORE PERSONAL PROPERTY (PORT-A-POTTIES, CONSTRUCTION EQUIPMENT, FENCES, ETC) OR OTHER MATERIALS IN THE RIGHT-OF-WAY, INCLUDING ON SIDEWALKS AND WITHIN PLANTERS, PER BEND CODE TITLE 3 AND TITLE 6.																																																		
	<div>CONSTRUCTION, INSPECTION, AND NOTIFICATION NOTES</div> <ol style="list-style-type: none">THE CONTRACTOR IS RESPONSIBLE FOR ANY DAMAGE TO PUBLIC AND PRIVATE PROPERTY. ALL DAMAGE INFLICTED BY THE CONTRACTOR (OR SUB-CONTRACTORS) DURING THE PROJECT'S CONSTRUCTION ACTIVITIES SHALL BE REPAIRED TO PRE-CONSTRUCTION CONDITIONS AND TO THE SATISFACTION OF THE PROPERTY OWNER.																																																		
	<div>GRADING AND ESC NOTES</div> <ol style="list-style-type: none">PRIOR TO ANY GRADING/CLEARING OF A PROJECT SITE, BMPS MUST BE INSTALLED, INSPECTED, AND APPROVED BY THE CITY OF BEND.PRIOR TO ANY GRADING/CLEARING OF THE PROJECT SITE, TREE PROTECTION FENCING MUST BE INSTALLED TO CITY OF BEND STANDARDS, INSPECTED AND APPROVED BY THE CITY OF BEND. ALL TREE PROTECTION FENCING MUST BE MAINTAINED AS APPROVED DURING THE PROGRESSION OF THE PROJECT.ESC PLAN(S) MUST BE KEPT ONSITE AT ALL TIMES WHEN WORK IS OCCURRING.THE ESC MEASURES SHOWN ON THIS PLAN ARE MINIMUM REQUIREMENTS FOR ANTICIPATED SITE CONDITIONS. DURING THE CONSTRUCTION PERIOD, THE MEASURES MUST BE UPGRADED AS NEEDED TO COMPLY WITH ALL APPLICABLE LOCAL, STATE, AND FEDERAL EROSION AND SEDIMENT CONTROL REGULATIONS.THE FOLLOWING CONSTRUCTION SEQUENCE SHALL BE FOLLOWED IN ORDER TO BEST MINIMIZE THE POTENTIAL FOR EROSION AND SEDIMENTATION CONTROL PROBLEMS:<div><div>A. FENCE OR FLAG AREAS TO BE PROTECTED OR LEFT UNDISTURBED DURING CONSTRUCTION. INSTALL TREE PROTECTION FENCING.</div><div>B. INSTALL GRAVELED OR PAVED CONSTRUCTION ENTRANCES, EXITS, AND PARKING AREAS TO REDUCE THE TRACKING OF SEDIMENT ONTO PUBLIC AND PRIVATE ROADS.</div><div>C. CLEAR AND GRUB SUFFICIENTLY FOR INSTALLATION OF TEMPORARY ESC BMPS.</div><div>D. INSTALL TEMPORARY ESC BMPS, CONSTRUCTING SEDIMENT TRAPPING BMPS AS ONE OF THE FIRST STEPS PRIOR TO GRADING.</div><div>E. CLEAR, GRUB AND GRADE INDIVIDUAL LOTS AND ROUGH GRADE FOR ROADS AND UTILITY LOCATIONS.</div><div>F. CLEAR, GRUB AND GRADE INDIVIDUAL LOTS OR GROUPS OF LOTS.</div><div>G. TEMPORARILY STABILIZE A LOT OR GROUPS OF LOTS, THROUGH RE-VEGETATION OR OTHER APPROPRIATE BMPS, WHERE SUBSTANTIAL CUT OR FILL SLOPES ARE THE RESULT OF SITE GRADING.</div><div>H. CONSTRUCT ROADS, BUILDINGS, PERMANENT STORMWATER FACILITIES (I.E. INLETS, PONDS, UIC FACILITIES, ETC.).</div><div>I. PROTECT ALL PERMANENT STORMWATER FACILITIES UTILIZING THE APPROPRIATE BMPS.</div><div>J. REMOVE TEMPORARY ESC CONTROLS WHEN PERMANENT STORMWATER FACILITIES HAVE BEEN INSTALLED. ALL LAND-DISTURBING ACTIVITIES HAVE CEASED, AND VEGETATION HAS BEEN ESTABLISHED IN THE AREAS NOTED ON THE ACCEPTED ESC PLAN(S).</div></div>RETAIN THE DUFF LAYER, NATIVE TOPSOIL, AND NATURAL VEGETATION IN AN UNDISTURBED STATE TO THE MAXIMUM EXTENT AND DURATION PRACTICAL.INSPECT ALL ROADWAYS ADJACENT TO THE CONSTRUCTION ACCESS ROUTE AT THE END OF EACH DAY. SEDIMENT THAT LEAVES THE CONSTRUCTION SITE MUST BE CLEANED UP WITHIN 24 HOURS. VACUUMING OR DRY SWEEPING MUST BE USED TO CLEAN UP RELEASED SEDIMENT AND SEDIMENT MUST NOT BE INTENTIONALLY WASHED INTO STORM SEWERS, DRAINAGE WAYS, OR WATER BODIES.RESTORE CONSTRUCTION ACCESS ROUTE EQUAL TO OR BETTER THAN THE PRE-CONSTRUCTION CONDITION.STABILIZE EXPOSED UNWORKED SOILS (INCLUDING STOCKPILES), WHETHER AT FINAL GRADE OR NOT, WITHIN 10 CALENDAR DAYS DURING THE REGIONAL DRY SEASON (JULY 1 THROUGH SEPTEMBER 30) AND WITHIN 5 CALENDAR DAYS DURING THE REGIONAL WET SEASON (OCTOBER 1 THROUGH JUNE 30).PROTECT INLETS, DRYWELLS, CATCH BASINS AND OTHER STORMWATER MANAGEMENT FACILITIES FROM SEDIMENT, WHETHER OR NOT FACILITIES ARE OPERABLE.KEEP ROADS ADJACENT TO INLETS CLEAN BY DRY SWEEPING. WASHING THE ROADWAYS WILL NOT BE PERMITTED.INSPECT INLETS WEEKLY AT A MINIMUM AND DAILY DURING AND AFTER STORM EVENTS. CLEAN OR REMOVE AND REPLACE INLET PROTECTION DEVICES BEFORE SIX INCHES OF SEDIMENT CAN ACCUMULATE.INSTALL SEDIMENT CONTROLS ALONG THE SITE PERIMETER ON ALL DOWN GRADIENT SIDES OF THE CONSTRUCTION SITE BEFORE COMMENCING EARTH DISTURBING ACTIVITIES.WHENEVER POSSIBLE, CONSTRUCT STORMWATER CONTROL FACILITIES (DETENTION/RETENTION STORAGE POND OR SWALES) BEFORE GRADING BEGINS. THESE FACILITIES SHOULD BE OPERATIONAL BEFORE THE CONSTRUCTION OF IMPERVIOUS SITE IMPROVEMENTS.STOCKPILE MATERIALS (SUCH AS TOPSOIL) ONSITE MUST BE KEPT OFF OF ROADWAY AND SIDEWALKS/PATHS/TRAILS.COVER, CONTAIN AND PROTECT ALL CHEMICALS, LIQUID PRODUCTS, PETROLEUM PRODUCT, AND NON-INERT WASTES PRESENT ONSITE FROM VANDALISM. MAINTAIN A SUPPLY OF MATERIALS ON HAND TO ADDRESS AND CONTAIN SPILLS.LOCATE DESIGNATED VEHICLE AND EQUIPMENT SERVICE AREAS, FUEL, AND MATERIALS AWAY FROM DRAINAGE INLETS, WATER COURSES, AND CANALS. PROPERLY CONTAIN AREAS USING BERMS, SAND BAGS, OR OTHER BARRIERS.REGULARLY INSPECT AND MAINTAIN EQUIPMENT, ESPECIALLY FOR DAMAGED HOSES AND LEAKY GASKETS. CONDUCT MAINTENANCE AND REPAIR OF HEAVY EQUIPMENT AND VEHICLES (I.E. OIL CHANGES, FUEL TANK DRAIN DOWN, ETC) THAT MAY RESULT IN DISCHARGE OR SPILLAGE OF POLLUTANTS USING SPILL PREVENTION MEASURES, SUCH AS DRIP PANS. CLEAN ALL CONTAMINATED SURFACES IMMEDIATELY FOLLOWING ANY DISCHARGE OR SPILL INCIDENT, PERFORM REPAIRS ONSITE USING TEMPORARY PLASTIC OR OIL ABSORBING BLANKETS BENEATH THE VEHICLE.APPLY LANDSCAPING OR AGRICULTURAL CHEMICALS, INCLUDING FERTILIZERS AND PESTICIDES, IN SUCH A MANNER, AND AT APPLICATIONS RATES, THAT PREVENTS THE RUNOFF OF CHEMICALS INTO STORMWATER FACILITIES.INSPECT ON A REGULAR BASIS (AT A MINIMUM WEEKLY, AND DAILY DURING/AFTER A RUNOFF PRODUCING STORM EVENT) AND MAINTAIN ALL EROSION AND SEDIMENT CONTROL BMPS TO ENSURE SUCCESSFUL PERFORMANCE OF THE BMPS.REMOVE TEMPORARY ESC BMPS WITHIN 30 DAYS AFTER THE TEMPORARY BMPS ARE NO LONGER NEEDED. PERMANENTLY STABILIZE AREAS THAT ARE DISTURBED DURING THE REMOVAL PROCESS.KEEP SEDIMENT ON THE PROJECT SITE, TO THE MAXIMUM EXTENT PRACTICAL.CONTROL FUGITIVE DUST FROM CONSTRUCTION ACTIVITY. DUST CONTROL MUST BE CONTINUOUS, PARTICULARLY DURING THE DRY SEASON.DESIGNATE THE LOCATION OF A SLURRY PIT WHERE CONCRETE TRUCKS AND EQUIPMENT CAN BE WASHED OUT. SLURRY PITS ARE NOT TO BE LOCATED IN, OR UPSTREAM OF, A SWALE, DRAINAGE AREA, STORMWATER FACILITY, WATER BODY, OR IN AN AREA WHERE A STORMWATER FACILITY EXISTS OR IS PROPOSED.																																																		
	<div>NOTICE TO EXCAVATORS: ATTENTION: OREGON LAW REQUIRES YOU TO FOLLOW RULES ADOPTED BY THE OREGON UTILITY NOTIFICATION CENTER. THOSE RULES ARE SET FORTH IN OAR 952-001-0010 THROUGH OAR 952-001-0090. YOU MAY OBTAIN COPIES OF THE RULES BY CALLING THE CENTER. (NOTE: THE TELEPHONE NUMBER FOR THE OREGON UTILITY NOTIFICATION CENTER IS (503)-232-1987).</div> <div>POTENTIAL UNDERGROUND FACILITY OWNERS Dig Safely. Call the Oregon One-Call Center 1-800-332-2344</div>																																																		
	1	2	3	4	5	6																																													

PRELIMINARY NOT
FOR CONSTRUCTION

GALVESTON PEDESTRIAN IMPROVEMENTS
CITY PROJECT #1TGCI
GENERAL NOTES
DESCHUTES COUNTY, OREGON



ENGINEERING

REVISIONS:

CITY OF BEND
ENGINEERING
710 NW WALL ST
BEND, OR 97701
541-330-4000

DESIGNED BY: DSE
DRAWN BY: DSE
SCALE: PER PLANS
FILE:
DATE: 11/04/2025

VERIFY SCALES
0 1"
BAR EQUALS ONE INCH
ON ORIGINAL DRAWING

SHEET:
G1.1
COB # 1TGCI

Plotted: 11/14/25 at 2:00pm By: dalmore

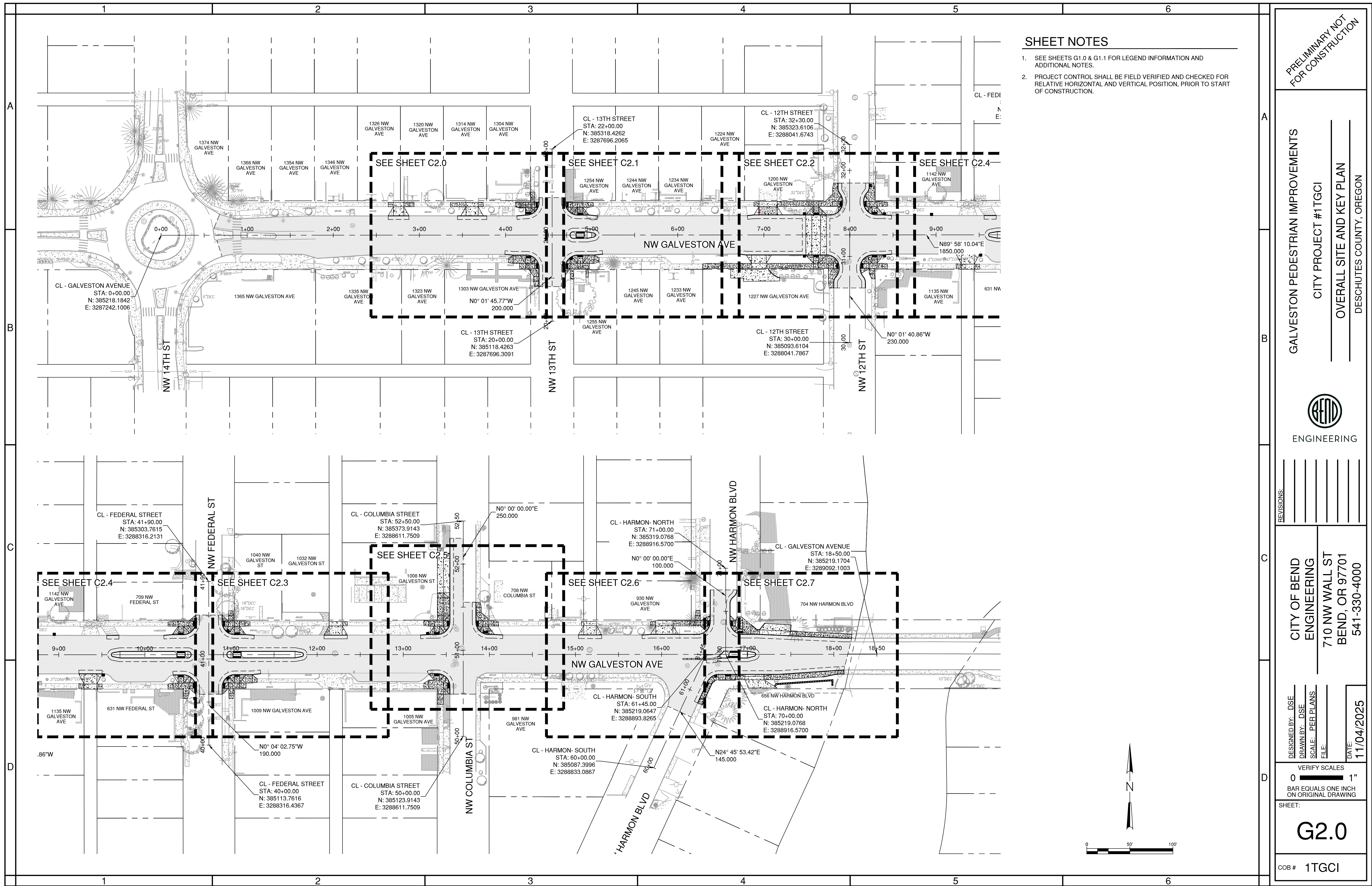

Plotted: 11/4/25 at 2:01pm By: dalmore

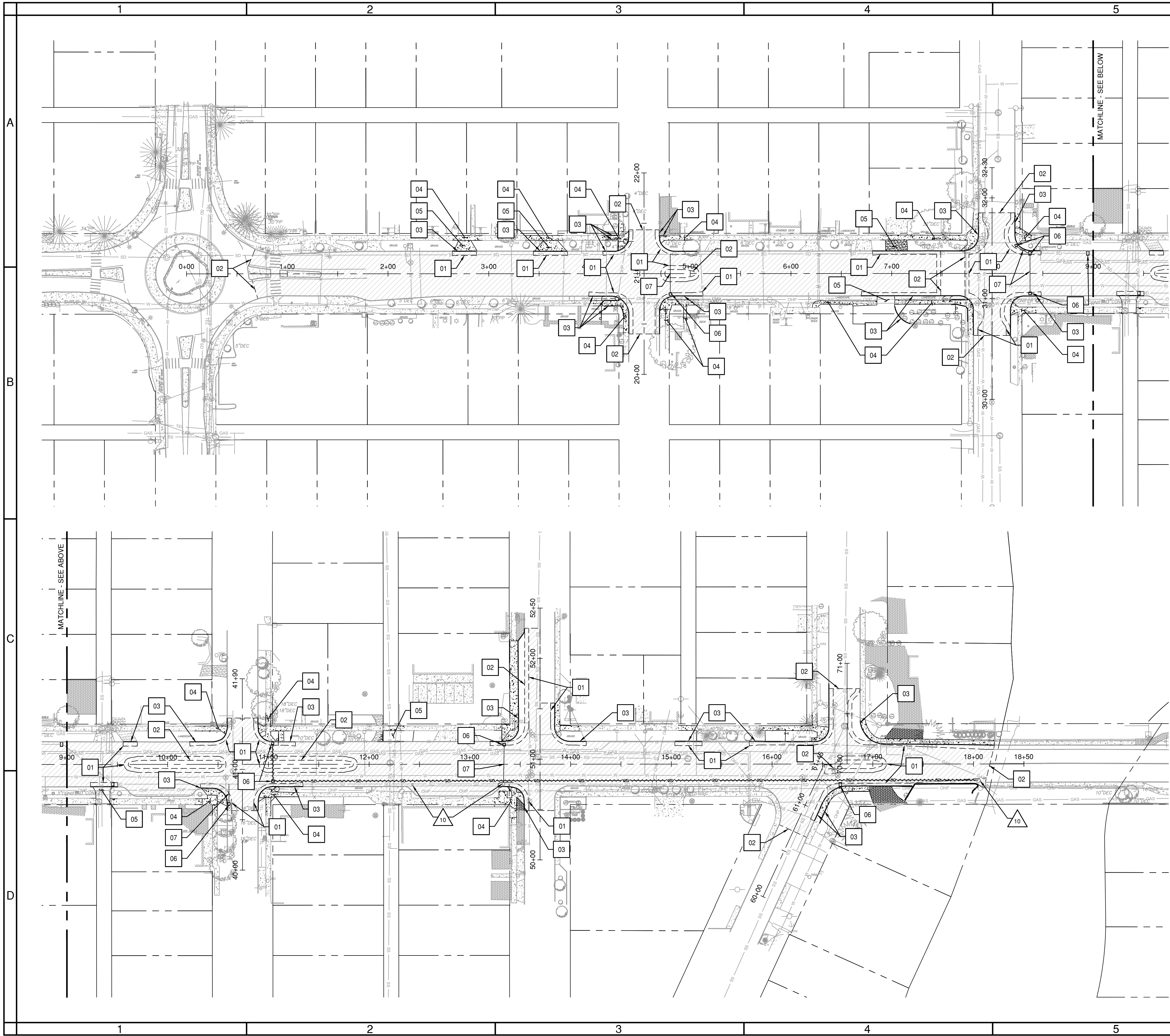

SHEET NOTES

- SEE SHEETS G1.0 & G1.1 FOR LEGEND INFORMATION AND ADDITIONAL NOTES.
- CONTRACTOR SHALL PRESERVE AND PROTECT FROM DAMAGE ALL EXISTING MONUMENTATION DURING CONSTRUCTION. THE CONTRACTOR IS RESPONSIBLE FOR COORDINATING AND PAYING FOR THE REPLACEMENT OF ANY MONUMENTS DAMAGED OR REMOVED DURING CONSTRUCTION. NEW MONUMENTS SHALL BE REESTABLISHED BY A LICENSED SURVEYOR.
- CONTRACTOR TO PROTECT ALL ITEMS ON ADJACENT PROPERTIES AND IN THE RIGHT OF WAY, NOT NOTED OTHERWISE. CONTRACTOR SHALL BE RESPONSIBLE FOR RESTORING ANY DAMAGED ITEMS TO ORIGINAL CONDITION OR BETTER.
- CONTRACTOR TO PROTECT ALL ADA RAMPS, DRIVEWAYS, CURBS, HARDSCAPE SURFACING AND PAVEMENT MARKINGS, NOT NOTED OTHERWISE.
- CONTRACTOR TO PROTECT ALL EXISTING UTILITIES, NOT NOTED OTHERWISE.
- CONTRACTOR IS RESPONSIBLE TO CONTROL DUST AND MUD DURING THE DEMOLITION PERIOD, AND DURING TRANSPORTATION OF DEMOLITION DEBRIS. ALL STREET SURFACES OUTSIDE THE CONSTRUCTION ZONE MUST BE KEPT CLEAN.
- CONCRETE CURBS AND CONCRETE HARDSCAPING NOTED FOR REMOVAL SHALL BE REMOVED TO THE NEAREST JOINT, NOT NOTED OTHERWISE.

X DEMOLITION NOTES

- SAWCUT AND REMOVE ASPHALT PAVEMENT AND BASE ROCK
- SAWCUT ASPHALT / GRIND AND INLAY LIMITS
- REMOVE EXISTING CURB
- REMOVE EXISTING SIDEWALK AT NEAREST JOINT LINE
- REMOVE EXISTING CONCRETE DRIVEWAY
- REMOVE EXISTING CATCH BASIN
- REMOVE EXISTING STORM LINE

X PROTECTION NOTES

- PROTECT STORM INLET, TO REMAIN

DEMOLITION LEGEND

- SAWCUT LINE
- 2" GRIND AND INLAY, MATCHING EXISTING GRADES
- SEWER MAIN / SERVICE TO BE ABANDONED IN PLACE

PRELIMINARY NOT
FOR CONSTRUCTION

GALVESTON PEDESTRIAN IMPROVEMENTS
CITY PROJECT #1TGCI
DEMOLITION PLAN
DESCHUTES COUNTY, OREGON



ENGINEERING

REVISIONS:

CITY OF BEND
ENGINEERING
710 NW WALL ST
BEND, OR 97701
541-330-4000

DESIGNED BY: DSE
DRAWN BY: DSE
SCALE: PER PLANS
FILE:
DATE: 11/04/2025

VERIFY SCALES
0 1"
BAR EQUALS ONE INCH
ON ORIGINAL DRAWING

SHEET:
C1.0

COB # 1TGCI

Plotted: 11/04/25 at 2:01pm By: dalmore

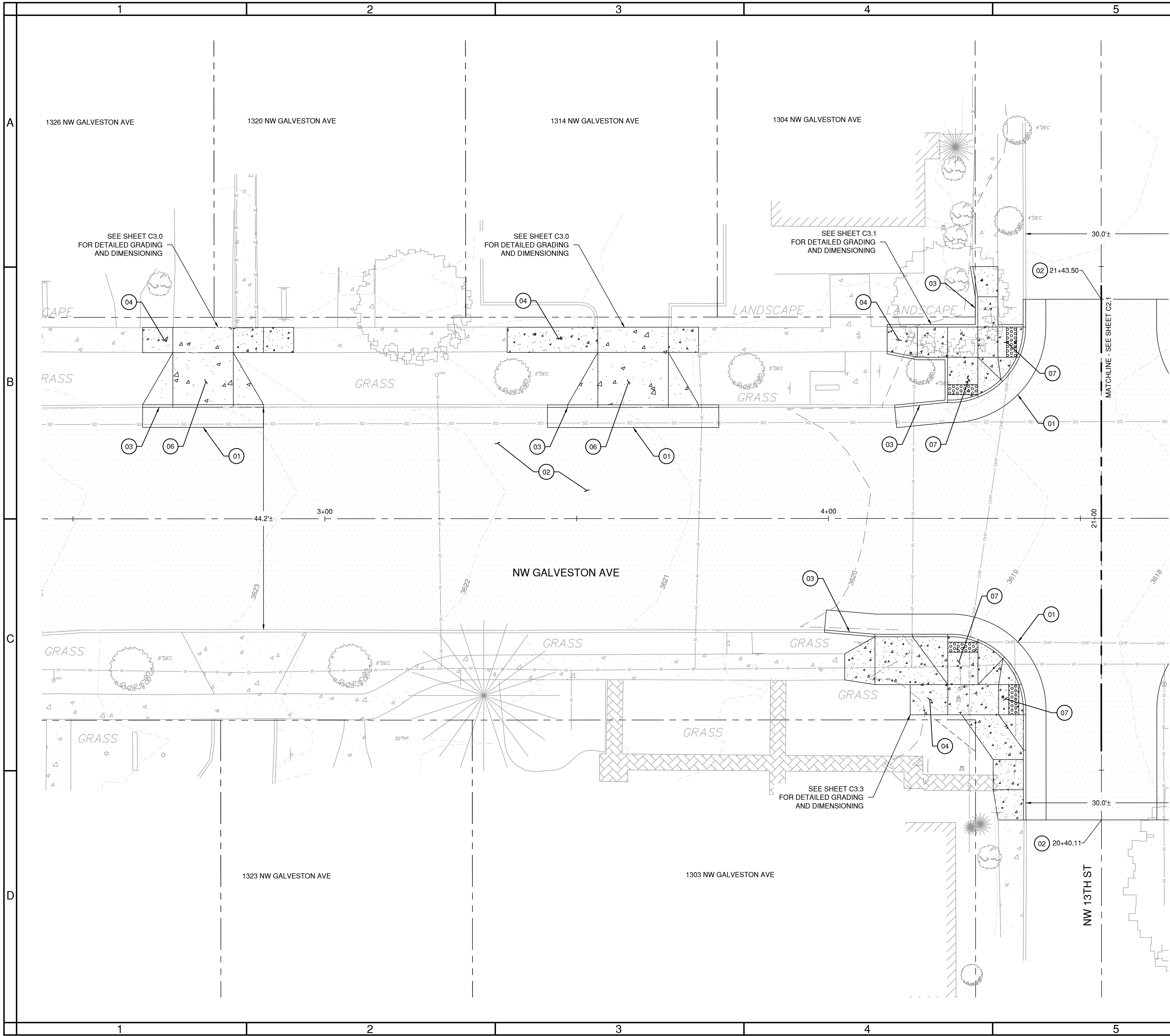

SHEET NOTES

- SEE SHEETS G1.0 & G1.1 FOR LEGEND INFORMATION AND ADDITIONAL NOTES.
- SEE SHEET C5.0 FOR PROPOSED TYPICAL ROAD SECTION INFORMATION.
- SEE CITY OF BEND STANDARD DRAWINGS R-4A AND R-4B ON SHEET C5.1 FOR SIDEWALK PAVEMENT JOINTING.
- CONTRACTOR TO PROTECT ALL ITEMS ON ADJACENT PROPERTIES AND IN THE RIGHT OF WAY NOT NOTED OTHERWISE. CONTRACTOR SHALL BE RESPONSIBLE FOR RESTORING ANY DAMAGED ITEMS TO ORIGINAL CONDITION.
- CONTRACTOR TO PROTECT ALL PAVEMENT MARKINGS NOT NOTED FOR REMOVAL. IF ANY PAVEMENT MARKING ARE DAMAGED IT IS THE CONTRACTORS RESPONSIBILITY TO REPLACE TO CURRENT OR BETTER CONDITIONS.
- LANDINGS ON ACCESSIBLE ROUTES SHALL NOT EXCEED 2% IN ANY DIRECTION. ALL ACCESSIBLE ROUTES SHALL COMPLY WITH CURRENT ADA ACCESSIBILITY GUIDELINES.
- PIPE BEDDING AND BACKFILL FOR ALL UTILITIES SHALL BE COMPLETED PER CITY OF BEND STANDARDS, SEE CITY OF BEND STANDARD DRAWING R-10 ON SHEET C5.2. IF TRENCHING OCCURS OUTSIDE OF THE PROPOSED ROADWAY RECONSTRUCTION RESTORATION SHALL BE COMPLETED PER CITY OF BEND STANDARDS, SEE CITY OF BEND STANDARD DRAWING R-11 ON SHEET C5.2.
- STRUCTURE LOCATIONS ARE BASED ON CENTER OF STRUCTURE.

CONSTRUCTION NOTES

- INSTALL ASPHALT SURFACING AND BASE, SEE CITY OF BEND STANDARD DRAWING R-1 ON SHEET C5.0
- INSTALL 2" GRIND AND INLAY OF EXISTING ASPHALT SURFACING MATCHING EXISTING GRADE, SEE CITY OF BEND STANDARD DRAWINGS R-1, R-1A AND R-1E ON SHEET C5.0
- INSTALL STANDARD CONCRETE CURB, SEE CITY OF BEND STANDARD DRAWINGS R-3 AND R-3A ON SHEET C5.0
- INSTALL CONCRETE SIDEWALK, SEE CITY OF BEND STANDARD DRAWINGS R-4A AND R-4B ON SHEET C5.1
- NOT USED
- INSTALL CONCRETE DRIVEWAY, SEE CITY OF BEND STANDARD DRAWING R-5A ON SHEET C5.1
- INSTALL CURB RAMP AND DETECTIBLE WARNING, SEE CITY OF BEND STANDARD DRAWINGS R-6, R-6A AND R-6C ON SHEET C5.1
- NOT USED
- NOT USED
- NOT USED
- NOT USED
- NOT USED
- NOT USED
- NOT USED

PRELIMINARY NOT
FOR CONSTRUCTION

GALVESTON PEDESTRIAN IMPROVEMENTS
CITY PROJECT #1TGCI
ROADWAY PLAN
DESCHUTES COUNTY, OREGON



ENGINEERING

REVISIONS:

CITY OF BEND
ENGINEERING
710 NW WALL ST
BEND, OR 97701
541-330-4000

DESIGNED BY: DSE
DRAWN BY: DSE
SCALE: PER PLANS
FILE:
DATE: 11/04/2025

VERIFY SCALES

0 1"
BAR EQUALS ONE INCH
ON ORIGINAL DRAWING

SHEET:

C2.0

COB # 1TGCI

Plotted: 11/4/25 at 2:01pm By: dalmore

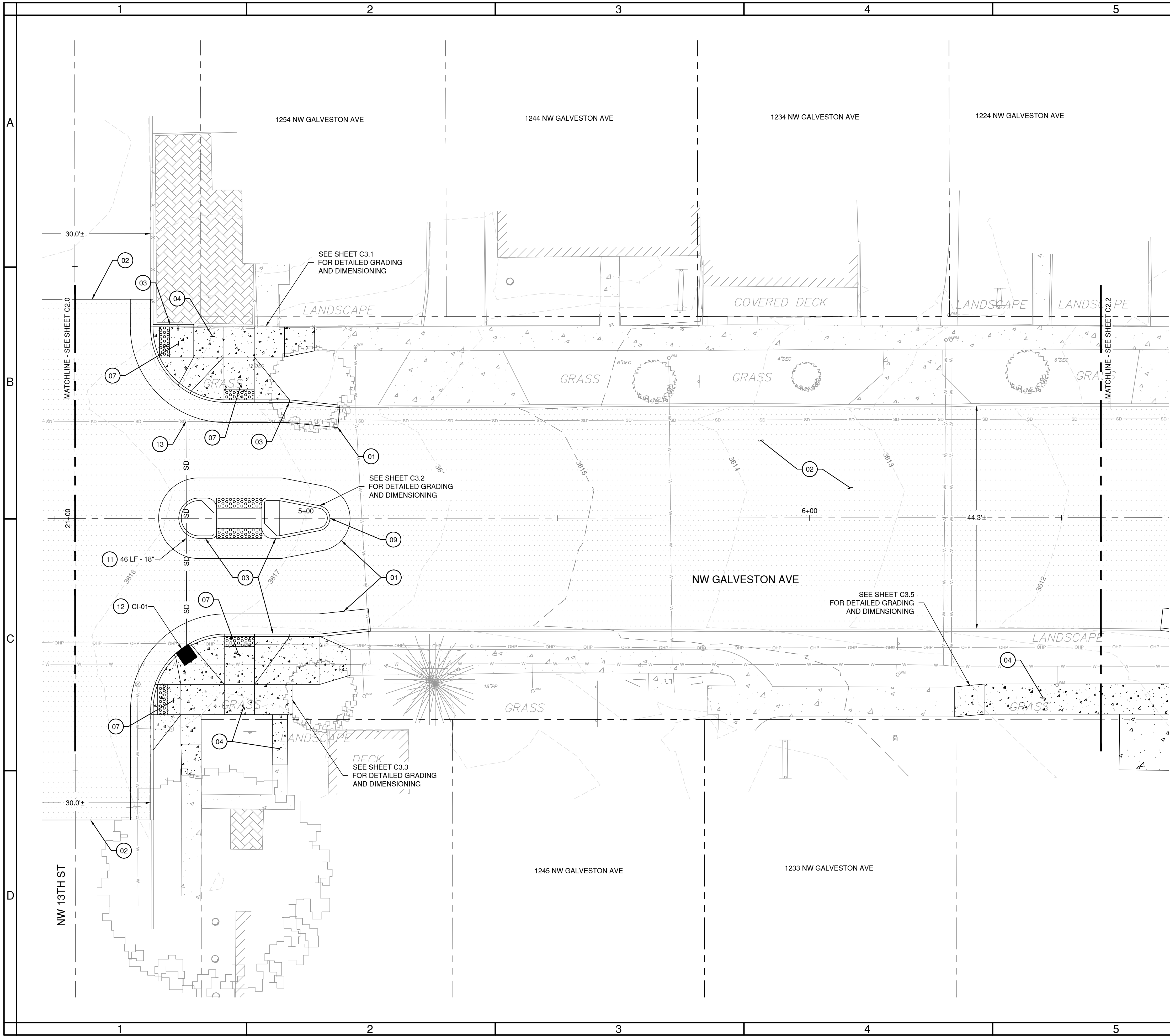

SHEET NOTES

- SEE SHEETS G1.0 & G1.1 FOR LEGEND INFORMATION AND ADDITIONAL NOTES.
- SEE SHEET C5.0 FOR PROPOSED TYPICAL ROAD SECTION INFORMATION.
- SEE CITY OF BEND STANDARD DRAWINGS R-4A AND R-4B ON SHEET C5.1 FOR SIDEWALK PAVEMENT JOINTING.
- CONTRACTOR TO PROTECT ALL ITEMS ON ADJACENT PROPERTIES AND IN THE RIGHT OF WAY NOT NOTED OTHERWISE. CONTRACTOR SHALL BE RESPONSIBLE FOR RESTORING ANY DAMAGED ITEMS TO ORIGINAL CONDITION.
- CONTRACTOR TO PROTECT ALL PAVEMENT MARKINGS NOT NOTED FOR REMOVAL. IF ANY PAVEMENT MARKING ARE DAMAGED IT IS THE CONTRACTORS RESPONSIBILITY TO REPLACE TO CURRENT OR BETTER CONDITIONS.
- LANDINGS ON ACCESSIBLE ROUTES SHALL NOT EXCEED 2% IN ANY DIRECTION. ALL ACCESSIBLE ROUTES SHALL COMPLY WITH CURRENT ADA ACCESSIBILITY GUIDELINES.
- PIPE BEDDING AND BACKFILL FOR ALL UTILITIES SHALL BE COMPLETED PER CITY OF BEND STANDARDS, SEE CITY OF BEND STANDARD DRAWING R-10 ON SHEET C5.2. IF TRENCHING OCCURS OUTSIDE OF THE PROPOSED ROADWAY RECONSTRUCTION RESTORATION SHALL BE COMPLETED PER CITY OF BEND STANDARDS, SEE CITY OF BEND STANDARD DRAWING R-11 ON SHEET C5.2.
- STRUCTURE LOCATIONS ARE BASED ON CENTER OF STRUCTURE.

(X) CONSTRUCTION NOTES

- INSTALL ASPHALT SURFACING AND BASE, SEE CITY OF BEND STANDARD DRAWING R-1 ON SHEET C5.0
- INSTALL 2" GRIND AND INLAY OF EXISTING ASPHALT SURFACING MATCHING EXISTING GRADE, SEE CITY OF BEND STANDARD DRAWINGS R-1, R-1A AND R-1E ON SHEET C5.0
- INSTALL STANDARD CONCRETE CURB, SEE CITY OF BEND STANDARD DRAWINGS R-3 AND R-3A ON SHEET C5.0
- INSTALL CONCRETE SIDEWALK, SEE CITY OF BEND STANDARD DRAWINGS R-4A AND R-4B ON SHEET C5.1
- NOT USED
- NOT USED
- INSTALL CURB RAMP AND DETECTIBLE WARNING, SEE CITY OF BEND STANDARD DRAWINGS R-6, R-6A AND R-6C ON SHEET C5.1
- NOT USED
- INSTALL MEDIAN / ISLAND, SEE CITY OF BEND STANDARD DRAWING R-25 ON SHEET C5.2
- NOT USED
- INSTALL PVC D3034 GRAVITY STORM MAIN, SIZE PER PLANS, SEE CITY OF BEND STANDARD DRAWING S-1 ON SHEET C5.2
- INSTALL STANDARD CURB INLET, SEE CITY OF BEND STANDARD DRAWING STRM-9 ON SHEET C5.2
- CONNECT TO EXISTING MAIN, FIELD VERIFY LOCATION AND IE OF EXISTING STORM MAIN PRIOR TO CONSTRUCTION
- NOT USED

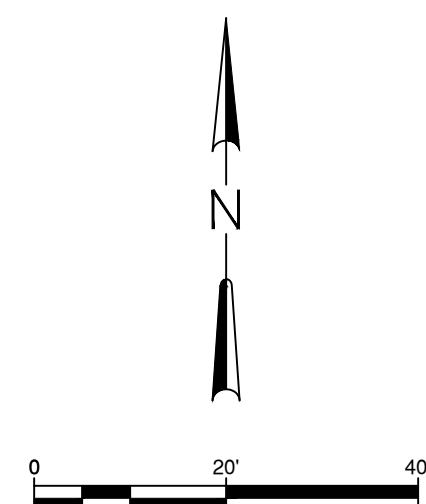

PRELIMINARY NOT
FOR CONSTRUCTION

GALVESTON PEDESTRIAN IMPROVEMENTS
CITY PROJECT #1TGCI
ROADWAY PLAN
DESCHUTES COUNTY, OREGON



ENGINEERING

REVISIONS:

--	--	--	--	--	--	--	--	--	--

CITY OF BEND
ENGINEERING
710 NW WALL ST
BEND, OR 97701
541-330-4000

DESIGNED BY: DSE
DRAWN BY: DSE
SCALE: PER PLANS
FILE:
DATE: 11/04/2025

VERIFIED SCALES
0 1"
BAR EQUALS ONE INCH
ON ORIGINAL DRAWING

SHEET:

C2.1

COB # 1TGCI

Plotted: 11/4/25 at 2:02pm By: dalmore

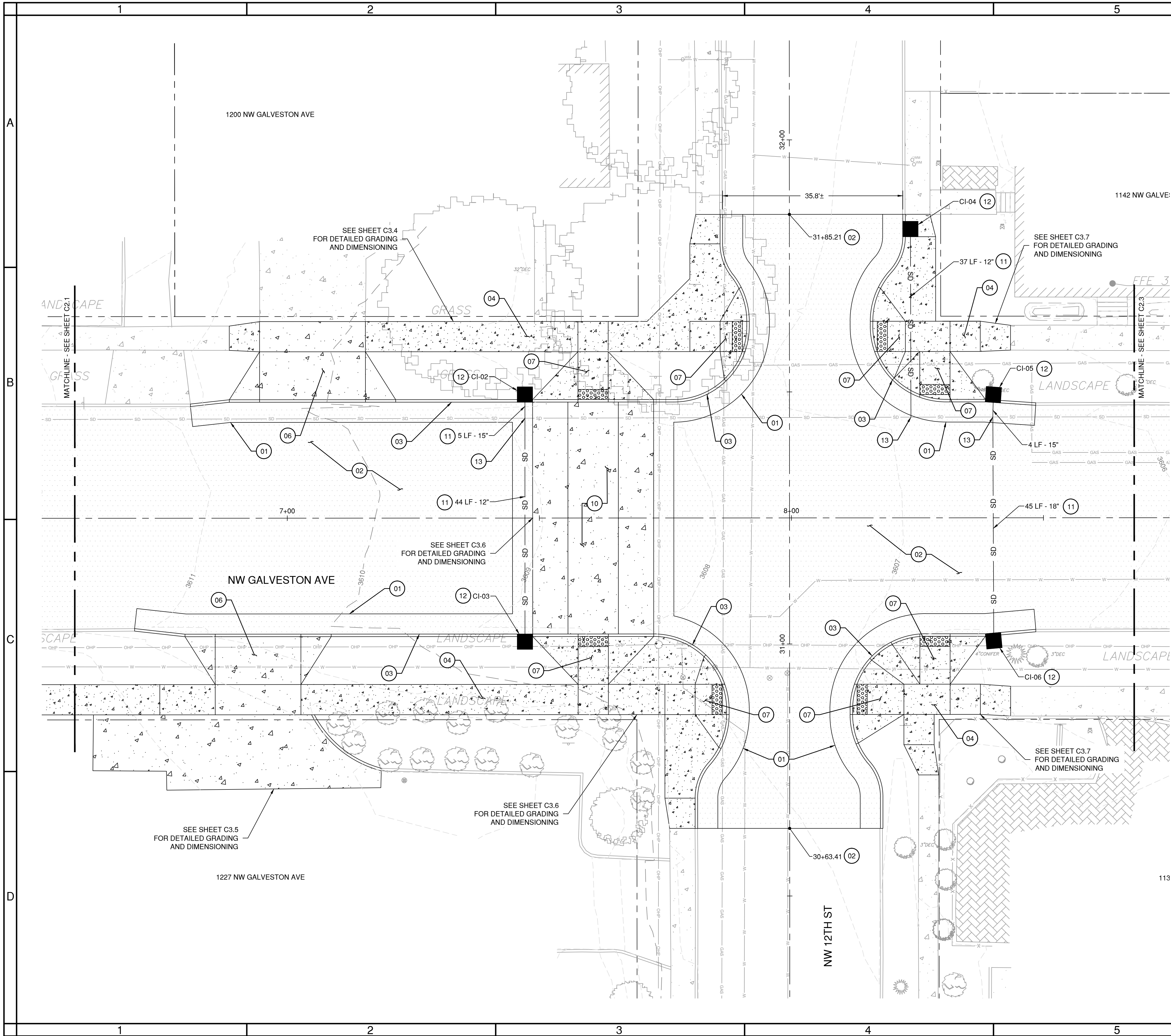

SHEET NOTES

- SEE SHEETS G1.0 & G1.1 FOR LEGEND INFORMATION AND ADDITIONAL NOTES.
- SEE SHEET C5.0 FOR PROPOSED TYPICAL ROAD SECTION INFORMATION.
- SEE CITY OF BEND STANDARD DRAWINGS R-4A AND R-4B ON SHEET C5.1 FOR SIDEWALK PAVEMENT JOINTING.
- CONTRACTOR TO PROTECT ALL ITEMS ON ADJACENT PROPERTIES AND IN THE RIGHT OF WAY NOT NOTED OTHERWISE. CONTRACTOR SHALL BE RESPONSIBLE FOR RESTORING ANY DAMAGED ITEMS TO ORIGINAL CONDITION.
- CONTRACTOR TO PROTECT ALL PAVEMENT MARKINGS NOT NOTED FOR REMOVAL. IF ANY PAVEMENT MARKING ARE DAMAGED IT IS THE CONTRACTORS RESPONSIBILITY TO REPLACE TO CURRENT OR BETTER CONDITIONS.
- LANDINGS ON ACCESSIBLE ROUTES SHALL NOT EXCEED 2% IN ANY DIRECTION. ALL ACCESSIBLE ROUTES SHALL COMPLY WITH CURRENT ADA ACCESSIBILITY GUIDELINES.
- PIPE BEDDING AND BACKFILL FOR ALL UTILITIES SHALL BE COMPLETED PER CITY OF BEND STANDARDS, SEE CITY OF BEND STANDARD DRAWING R-10 ON SHEET C5.2. IF TRENCHING OCCURS OUTSIDE OF THE PROPOSED ROADWAY RECONSTRUCTION RESTORATION SHALL BE COMPLETED PER CITY OF BEND STANDARDS, SEE CITY OF BEND STANDARD DRAWING R-11 ON SHEET C5.2.
- STRUCTURE LOCATIONS ARE BASED ON CENTER OF STRUCTURE.

(X) CONSTRUCTION NOTES

- INSTALL ASPHALT SURFACING AND BASE, SEE CITY OF BEND STANDARD DRAWING R-1 ON SHEET C5.0
- INSTALL 2" GRIND AND INLAY OF EXISTING ASPHALT SURFACING MATCHING EXISTING GRADE, SEE CITY OF BEND STANDARD DRAWINGS R-1, R-1A AND R-1E ON SHEET C5.0
- INSTALL STANDARD CONCRETE CURB, SEE CITY OF BEND STANDARD DRAWINGS R-3 AND R-3A ON SHEET C5.0
- INSTALL CONCRETE SIDEWALK, SEE CITY OF BEND STANDARD DRAWINGS R-4A AND R-4B ON SHEET C5.1
- NOT USED
- INSTALL CONCRETE DRIVEWAY, SEE CITY OF BEND STANDARD DRAWING R-5A ON SHEET C5.1
- INSTALL CURB RAMP AND DETECTIBLE WARNING, SEE CITY OF BEND STANDARD DRAWINGS R-6, R-6A AND R-6C ON SHEET C5.1
- NOT USED
- NOT USED
- INSTALL RAISED CROSSWALK, SEE CITY OF BEND STANDARD DRAWING R-33 ON SHEET C5.2
- INSTALL PVC D3034 GRAVITY STORM MAIN, SIZE PER PLANS, SEE CITY OF BEND STANDARD DRAWING S-1 ON SHEET C5.2
- INSTALL STANDARD CURB INLET, SEE CITY OF BEND STANDARD DRAWING STRM-9 ON SHEET C5.2
- CONNECT TO EXISTING MAIN, FIELD VERIFY LOCATION AND IE OF EXISTING STORM MAIN PRIOR TO CONSTRUCTION
- NOT USED

PRELIMINARY NOT
FOR CONSTRUCTION

GALVESTON PEDESTRIAN IMPROVEMENTS
CITY PROJECT #1TGCI
ROADWAY PLAN
DESCHUTES COUNTY, OREGON



ENGINEERING

REVISIONS:

CITY OF BEND
ENGINEERING
710 NW WALL ST
BEND, OR 97701
541-330-4000

DESIGNED BY: DSE
DRAWN BY: DSE
SCALE: PER PLANS
FILE:
DATE: 11/04/2025

VERIFY SCALES
0 1"
BAR EQUALS ONE INCH
ON ORIGINAL DRAWING

SHEET:
C2.2

COB # 1TGCI

Plotted: 11/4/25 at 2:02pm By: dalmore

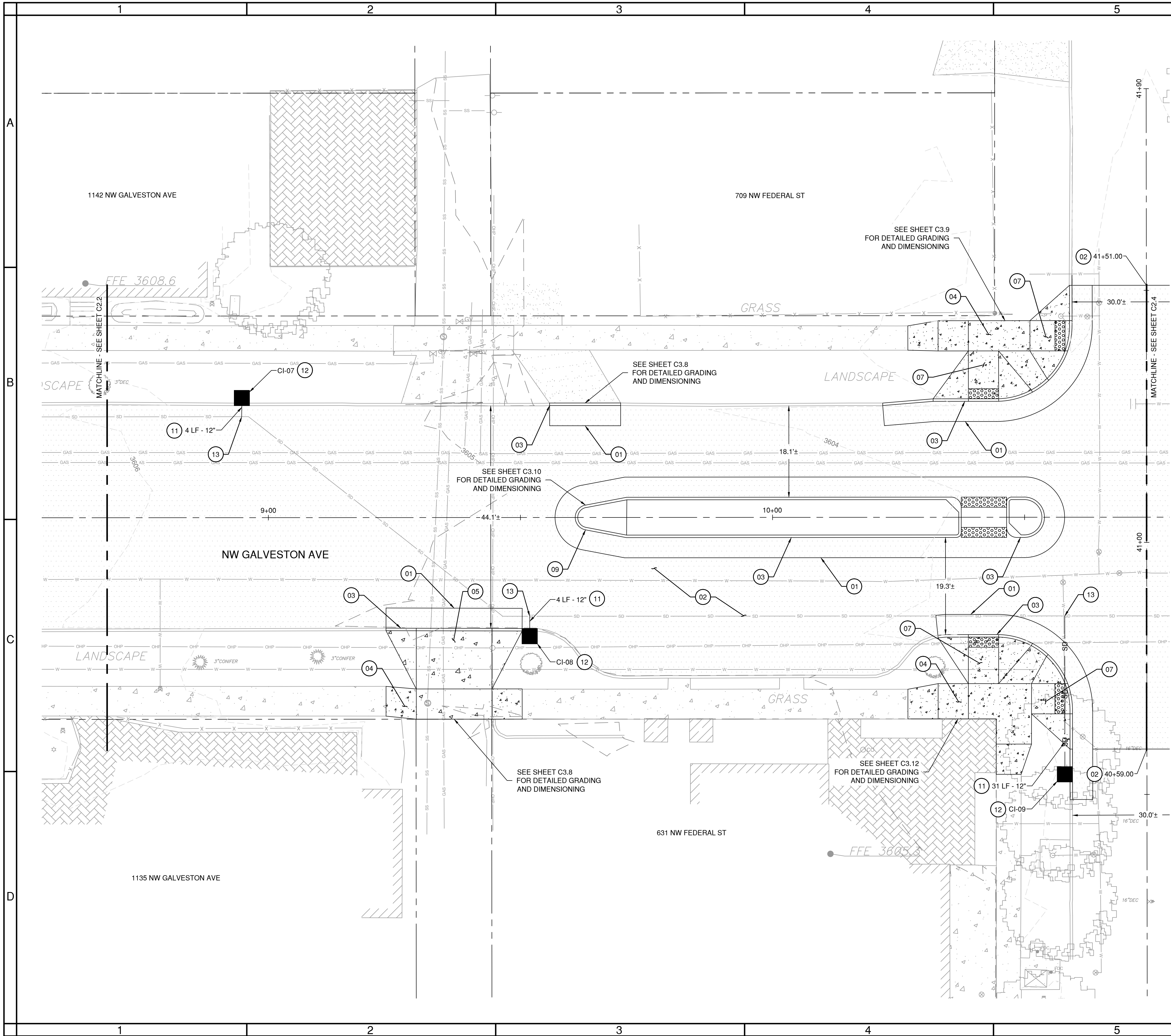

SHEET NOTES

- SEE SHEETS G1.0 & G1.1 FOR LEGEND INFORMATION AND ADDITIONAL NOTES.
- SEE SHEET C5.0 FOR PROPOSED TYPICAL ROAD SECTION INFORMATION.
- SEE CITY OF BEND STANDARD DRAWINGS R-4A AND R-4B ON SHEET C5.1 FOR SIDEWALK PAVEMENT JOINTING.
- CONTRACTOR TO PROTECT ALL ITEMS ON ADJACENT PROPERTIES AND IN THE RIGHT OF WAY NOT NOTED OTHERWISE. CONTRACTOR SHALL BE RESPONSIBLE FOR RESTORING ANY DAMAGED ITEMS TO ORIGINAL CONDITION.
- CONTRACTOR TO PROTECT ALL PAVEMENT MARKINGS NOT NOTED FOR REMOVAL. IF ANY PAVEMENT MARKING ARE DAMAGED IT IS THE CONTRACTORS RESPONSIBILITY TO REPLACE TO CURRENT OR BETTER CONDITIONS.
- LANDINGS ON ACCESSIBLE ROUTES SHALL NOT EXCEED 2% IN ANY DIRECTION. ALL ACCESSIBLE ROUTES SHALL COMPLY WITH CURRENT ADA ACCESSIBILITY GUIDELINES.
- PIPE BEDDING AND BACKFILL FOR ALL UTILITIES SHALL BE COMPLETED PER CITY OF BEND STANDARDS, SEE CITY OF BEND STANDARD DRAWING R-10 ON SHEET C5.2. IF TRENCHING OCCURS OUTSIDE OF THE PROPOSED ROADWAY RECONSTRUCTION RESTORATION SHALL BE COMPLETED PER CITY OF BEND STANDARDS. SEE CITY OF BEND STANDARD DRAWING R-11 ON SHEET C5.2.
- STRUCTURE LOCATIONS ARE BASED ON CENTER OF STRUCTURE.

(X) CONSTRUCTION NOTES

- INSTALL ASPHALT SURFACING AND BASE, SEE CITY OF BEND STANDARD DRAWING R-1 ON SHEET C5.0
- INSTALL 2" GRIND AND INLAY OF EXISTING ASPHALT SURFACING MATCHING EXISTING GRADE, SEE CITY OF BEND STANDARD DRAWINGS R-1, R-1A AND R-1E ON SHEET C5.0
- INSTALL STANDARD CONCRETE CURB, SEE CITY OF BEND STANDARD DRAWINGS R-3 AND R-3A ON SHEET C5.0
- INSTALL CONCRETE SIDEWALK, SEE CITY OF BEND STANDARD DRAWINGS R-4A AND R-4B ON SHEET C5.1
- INSTALL ALLEY DRIVEWAY, SEE CITY OF BEND STANDARD DRAWINGS R-1J ON SHEET C5.0 AND R-5A ON SHEET C5.1
- NOT USED
- INSTALL CURB RAMP AND DETECTIBLE WARNING, SEE CITY OF BEND STANDARD DRAWINGS R-6, R-6A AND R-6C ON SHEET C5.1
- NOT USED
- INSTALL MEDIAN / ISLAND, SEE CITY OF BEND STANDARD DRAWING R-25 ON SHEET C5.2
- NOT USED
- INSTALL PVC D3034 GRAVITY STORM MAIN, SIZE PER PLANS, SEE CITY OF BEND STANDARD DRAWING S-1 ON SHEET C5.2
- INSTALL STANDARD CURB INLET, SEE CITY OF BEND STANDARD DRAWING STRM-9 ON SHEET C5.2
- CONNECT TO EXISTING MAIN, FIELD VERIFY LOCATION AND IE OF EXISTING STORM MAIN PRIOR TO CONSTRUCTION
- NOT USED

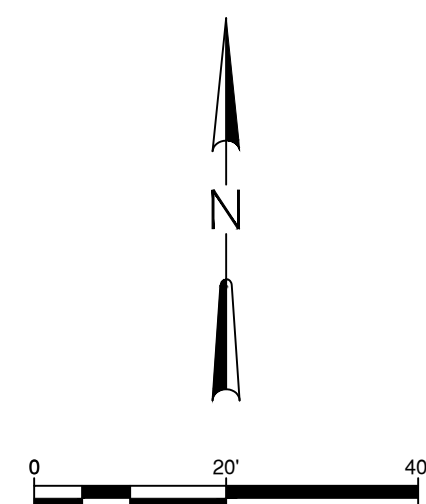

PRELIMINARY NOT
FOR CONSTRUCTION

GALVESTON PEDESTRIAN IMPROVEMENTS
CITY PROJECT #1TGCI
ROADWAY PLAN
DESCHUTES COUNTY, OREGON



ENGINEERING

REVISIONS:

CITY OF BEND
ENGINEERING
710 NW WALL ST
BEND, OR 97701
541-330-4000

DESIGNED BY: DSE
DRAWN BY: DSE
SCALE: PER PLANS
FILE:
DATE: 11/04/2025

VERIFY SCALES
0 1"
BAR EQUALS ONE INCH
ON ORIGINAL DRAWING

SHEET:

C2.3

COB # 1TGCI

Plotted: 11/4/25 at 2:02pm By: dalmore

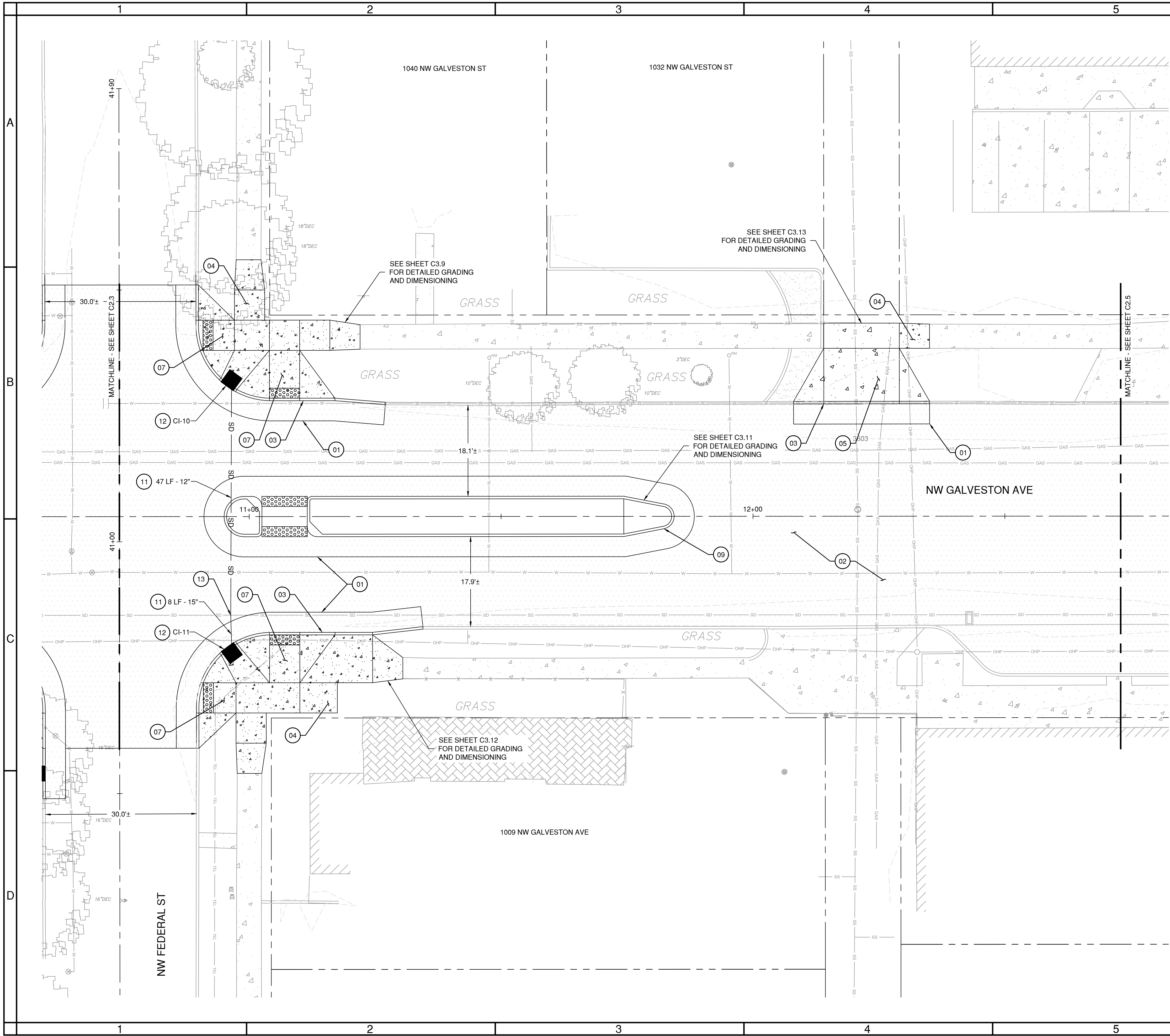

SHEET NOTES

- SEE SHEETS G1.0 & G1.1 FOR LEGEND INFORMATION AND ADDITIONAL NOTES.
- SEE SHEET C5.0 FOR PROPOSED TYPICAL ROAD SECTION INFORMATION.
- SEE CITY OF BEND STANDARD DRAWINGS R-4A AND R-4B ON SHEET C5.1 FOR SIDEWALK PAVEMENT JOINTING.
- CONTRACTOR TO PROTECT ALL ITEMS ON ADJACENT PROPERTIES AND IN THE RIGHT OF WAY NOT NOTED OTHERWISE. CONTRACTOR SHALL BE RESPONSIBLE FOR RESTORING ANY DAMAGED ITEMS TO ORIGINAL CONDITION.
- CONTRACTOR TO PROTECT ALL PAVEMENT MARKINGS NOT NOTED FOR REMOVAL. IF ANY PAVEMENT MARKING ARE DAMAGED IT IS THE CONTRACTORS RESPONSIBILITY TO REPLACE TO CURRENT OR BETTER CONDITIONS.
- LANDINGS ON ACCESSIBLE ROUTES SHALL NOT EXCEED 2% IN ANY DIRECTION. ALL ACCESSIBLE ROUTES SHALL COMPLY WITH CURRENT ADA ACCESSIBILITY GUIDELINES.
- PIPE BEDDING AND BACKFILL FOR ALL UTILITIES SHALL BE COMPLETED PER CITY OF BEND STANDARDS, SEE CITY OF BEND STANDARD DRAWING R-10 ON SHEET C5.2. IF TRENCHING OCCURS OUTSIDE OF THE PROPOSED ROADWAY RECONSTRUCTION RESTORATION SHALL BE COMPLETED PER CITY OF BEND STANDARDS, SEE CITY OF BEND STANDARD DRAWING R-11 ON SHEET C5.2.
- STRUCTURE LOCATIONS ARE BASED ON CENTER OF STRUCTURE.

CONSTRUCTION NOTES

- INSTALL ASPHALT SURFACING AND BASE, SEE CITY OF BEND STANDARD DRAWING R-1 ON SHEET C5.0
- INSTALL 2" GRIND AND INLAY OF EXISTING ASPHALT SURFACING MATCHING EXISTING GRADE, SEE CITY OF BEND STANDARD DRAWINGS R-1, R-1A AND R-1E ON SHEET C5.0
- INSTALL STANDARD CONCRETE CURB, SEE CITY OF BEND STANDARD DRAWINGS R-3 AND R-3A ON SHEET C5.0
- INSTALL CONCRETE SIDEWALK, SEE CITY OF BEND STANDARD DRAWINGS R-4A AND R-4B ON SHEET C5.1
- INSTALL ALLEY DRIVEWAY, SEE CITY OF BEND STANDARD DRAWINGS R-1J ON SHEET C5.0 AND R-5A ON SHEET C5.1
- NOT USED
- INSTALL CURB RAMP AND DETECTIBLE WARNING, SEE CITY OF BEND STANDARD DRAWINGS R-6, R-6A AND R-6C ON SHEET C5.1
- NOT USED
- INSTALL MEDIAN / ISLAND, SEE CITY OF BEND STANDARD DRAWING R-25 ON SHEET C5.2
- NOT USED
- INSTALL PVC D3034 GRAVITY STORM MAIN, SIZE PER PLANS, SEE CITY OF BEND STANDARD DRAWING S-1 ON SHEET C5.2
- INSTALL STANDARD CURB INLET, SEE CITY OF BEND STANDARD DRAWING STRM-9 ON SHEET C5.2
- CONNECT TO EXISTING MAIN, FIELD VERIFY LOCATION AND IE OF EXISTING STORM MAIN PRIOR TO CONSTRUCTION
- NOT USED

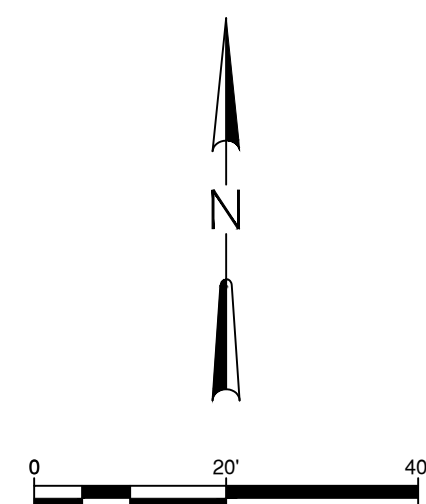

PRELIMINARY NOT
FOR CONSTRUCTION

GALVESTON PEDESTRIAN IMPROVEMENTS
CITY PROJECT #1TGCI
ROADWAY PLAN
DESCHUTES COUNTY, OREGON



ENGINEERING

REVISIONS:

CITY OF BEND
ENGINEERING
710 NW WALL ST
BEND, OR 97701
541-330-4000

DESIGNED BY: DSE
DRAWN BY: DSE
SCALE: PER PLANS
FILE:
DATE: 11/04/2025

VERIFY SCALES
0 1"
BAR EQUALS ONE INCH
ON ORIGINAL DRAWING

SHEET:
C2.4

COB # 1TGCI

Plotted: 11/4/25 at 2:02pm By: dalmore

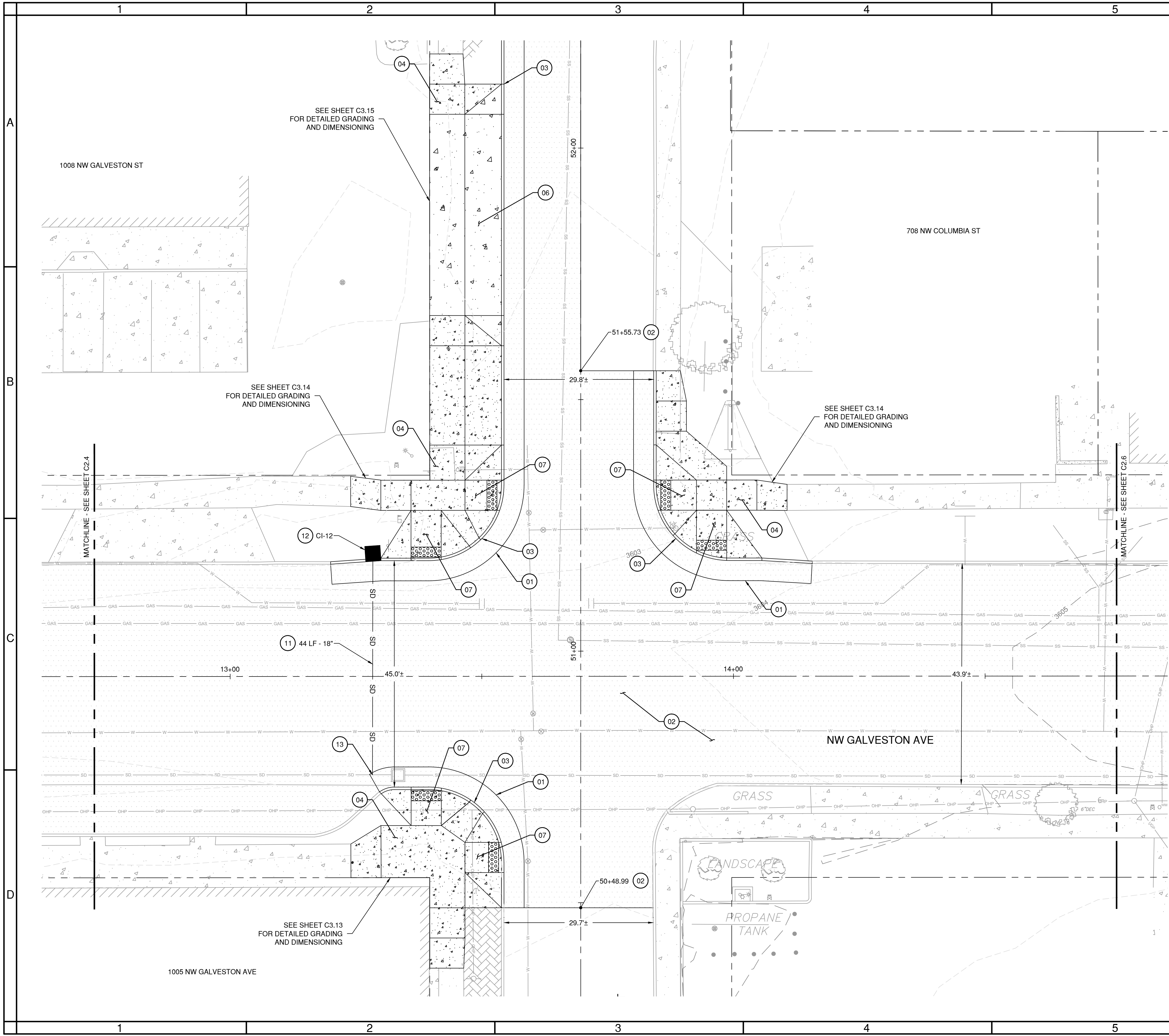

SHEET NOTES

- SEE SHEETS G1.0 & G1.1 FOR LEGEND INFORMATION AND ADDITIONAL NOTES.
- SEE SHEET C5.0 FOR PROPOSED TYPICAL ROAD SECTION INFORMATION.
- SEE CITY OF BEND STANDARD DRAWINGS R-4A AND R-4B ON SHEET C5.1 FOR SIDEWALK PAVEMENT JOINTING.
- CONTRACTOR TO PROTECT ALL ITEMS ON ADJACENT PROPERTIES AND IN THE RIGHT OF WAY NOT NOTED OTHERWISE. CONTRACTOR SHALL BE RESPONSIBLE FOR RESTORING ANY DAMAGED ITEMS TO ORIGINAL CONDITION.
- CONTRACTOR TO PROTECT ALL PAVEMENT MARKINGS NOT NOTED FOR REMOVAL. IF ANY PAVEMENT MARKING ARE DAMAGED IT IS THE CONTRACTORS RESPONSIBILITY TO REPLACE TO CURRENT OR BETTER CONDITIONS.
- LANDINGS ON ACCESSIBLE ROUTES SHALL NOT EXCEED 2% IN ANY DIRECTION. ALL ACCESSIBLE ROUTES SHALL COMPLY WITH CURRENT ADA ACCESSIBILITY GUIDELINES.
- PIPE BEDDING AND BACKFILL FOR ALL UTILITIES SHALL BE COMPLETED PER CITY OF BEND STANDARDS, SEE CITY OF BEND STANDARD DRAWING R-10 ON SHEET C5.2. IF TRENCHING OCCURS OUTSIDE OF THE PROPOSED ROADWAY RECONSTRUCTION RESTORATION SHALL BE COMPLETED PER CITY OF BEND STANDARDS, SEE CITY OF BEND STANDARD DRAWING R-11 ON SHEET C5.2.
- STRUCTURE LOCATIONS ARE BASED ON CENTER OF STRUCTURE.

CONSTRUCTION NOTES

- INSTALL ASPHALT SURFACING AND BASE, SEE CITY OF BEND STANDARD DRAWING R-1 ON SHEET C5.0
- INSTALL 2" GRIND AND INLAY OF EXISTING ASPHALT SURFACING MATCHING EXISTING GRADE, SEE CITY OF BEND STANDARD DRAWINGS R-1, R-1A AND R-1E ON SHEET C5.0
- INSTALL STANDARD CONCRETE CURB, SEE CITY OF BEND STANDARD DRAWINGS R-3 AND R-3A ON SHEET C5.0
- INSTALL CONCRETE SIDEWALK, SEE CITY OF BEND STANDARD DRAWINGS R-4A AND R-4B ON SHEET C5.1
- NOT USED
- INSTALL CONCRETE DRIVEWAY, SEE CITY OF BEND STANDARD DRAWING R-5A ON SHEET C5.1
- INSTALL CURB RAMP AND DETECTIBLE WARNING, SEE CITY OF BEND STANDARD DRAWINGS R-6, R-6A AND R-6C ON SHEET C5.1
- NOT USED
- INSTALL MEDIAN / ISLAND, SEE CITY OF BEND STANDARD DRAWING R-25 ON SHEET C5.2
- NOT USED
- INSTALL PVC D3034 GRAVITY STORM MAIN, SIZE PER PLANS, SEE CITY OF BEND STANDARD DRAWING S-1 ON SHEET C5.2
- INSTALL STANDARD CURB INLET, SEE CITY OF BEND STANDARD DRAWING STRM-9 ON SHEET C5.2
- CONNECT TO EXISTING MAIN, FIELD VERIFY LOCATION AND IE OF EXISTING STORM MAIN PRIOR TO CONSTRUCTION
- NOT USED

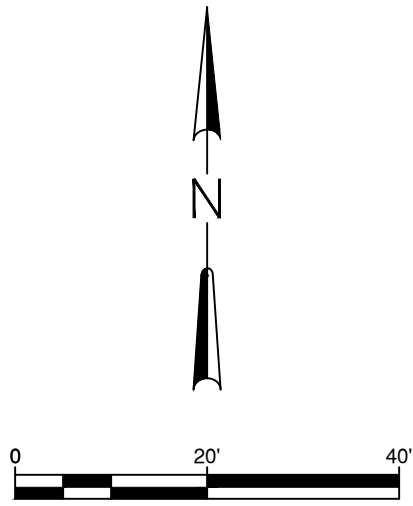

PRELIMINARY NOT
FOR CONSTRUCTION

GALVESTON PEDESTRIAN IMPROVEMENTS
CITY PROJECT #1TGCI
ROADWAY PLAN
DESCHUTES COUNTY, OREGON



ENGINEERING

REVISIONS:

CITY OF BEND
ENGINEERING
710 NW WALL ST
BEND, OR 97701
541-330-4000

DESIGNED BY: DSE
DRAWN BY: DSE
SCALE: PER PLANS
FILE:
DATE: 11/04/2025

VERIFY SCALES
0 1"
BAR EQUALS ONE INCH
ON ORIGINAL DRAWING

SHEET:
C2.5

COB # 1TGCI

Plotted: 11/14/25 at 2:02pm By: dalmore

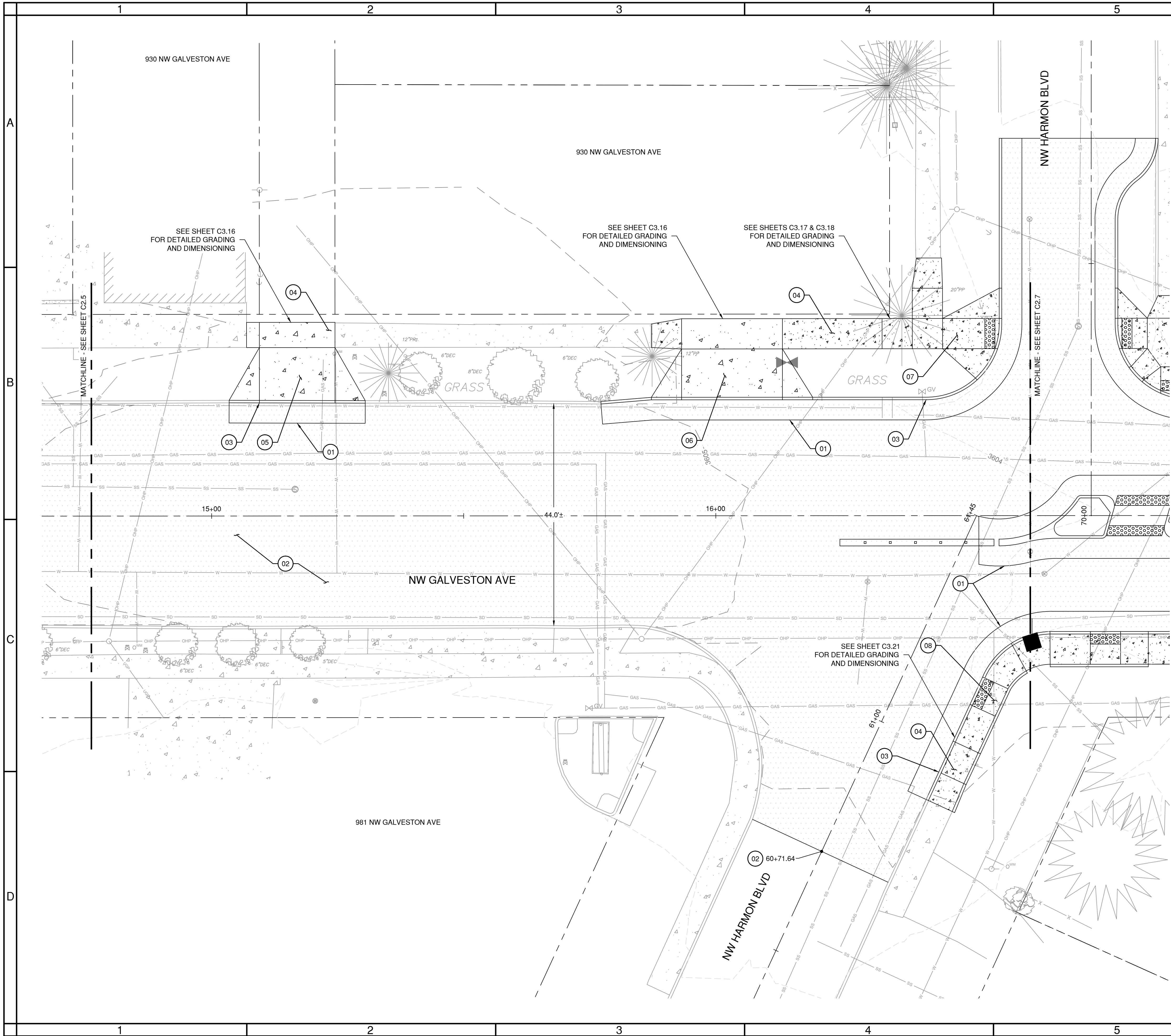

SHEET NOTES

- SEE SHEETS G1.0 & G1.1 FOR LEGEND INFORMATION AND ADDITIONAL NOTES.
- SEE SHEET C5.0 FOR PROPOSED TYPICAL ROAD SECTION INFORMATION.
- SEE CITY OF BEND STANDARD DRAWINGS R-4A AND R-4B ON SHEET C5.1 FOR SIDEWALK PAVEMENT JOINTING.
- CONTRACTOR TO PROTECT ALL ITEMS ON ADJACENT PROPERTIES AND IN THE RIGHT OF WAY NOT NOTED OTHERWISE. CONTRACTOR SHALL BE RESPONSIBLE FOR RESTORING ANY DAMAGED ITEMS TO ORIGINAL CONDITION.
- CONTRACTOR TO PROTECT ALL PAVEMENT MARKINGS NOT NOTED FOR REMOVAL. IF ANY PAVEMENT MARKING ARE DAMAGED IT IS THE CONTRACTORS RESPONSIBILITY TO REPLACE TO CURRENT OR BETTER CONDITIONS.
- LANDINGS ON ACCESSIBLE ROUTES SHALL NOT EXCEED 2% IN ANY DIRECTION. ALL ACCESSIBLE ROUTES SHALL COMPLY WITH CURRENT ADA ACCESSIBILITY GUIDELINES.
- PIPE BEDDING AND BACKFILL FOR ALL UTILITIES SHALL BE COMPLETED PER CITY OF BEND STANDARDS, SEE CITY OF BEND STANDARD DRAWING R-10 ON SHEET C5.2. IF TRENCHING OCCURS OUTSIDE OF THE PROPOSED ROADWAY RECONSTRUCTION RESTORATION SHALL BE COMPLETED PER CITY OF BEND STANDARDS, SEE CITY OF BEND STANDARD DRAWING R-11 ON SHEET C5.2.
- STRUCTURE LOCATIONS ARE BASED ON CENTER OF STRUCTURE.

(X) CONSTRUCTION NOTES

- INSTALL ASPHALT SURFACING AND BASE, SEE CITY OF BEND STANDARD DRAWING R-1 ON SHEET C5.0
- INSTALL 2" GRIND AND INLAY OF EXISTING ASPHALT SURFACING MATCHING EXISTING GRADE, SEE CITY OF BEND STANDARD DRAWINGS R-1, R-1A AND R-1E ON SHEET C5.0
- INSTALL STANDARD CONCRETE CURB, SEE CITY OF BEND STANDARD DRAWINGS R-3 AND R-3A ON SHEET C5.0
- INSTALL CONCRETE SIDEWALK, SEE CITY OF BEND STANDARD DRAWINGS R-4A AND R-4B ON SHEET C5.1
- INSTALL ALLEY DRIVEWAY, SEE CITY OF BEND STANDARD DRAWINGS R-1J ON SHEET C5.0 AND R-5A ON SHEET C5.1
- INSTALL CONCRETE DRIVEWAY, SEE CITY OF BEND STANDARD DRAWING R-5A ON SHEET C5.1
- INSTALL CURB RAMP AND DETECTIBLE WARNING, SEE CITY OF BEND STANDARD DRAWINGS R-6, R-6A AND R-6C ON SHEET C5.1
- INSTALL CURB RAMP AND DETECTIBLE WARNING, SEE CITY OF BEND STANDARD DRAWINGS R-6, R-6B AND R-6C ON SHEET C5.1
- NOT USED
- NOT USED
- NOT USED
- NOT USED
- NOT USED
- NOT USED

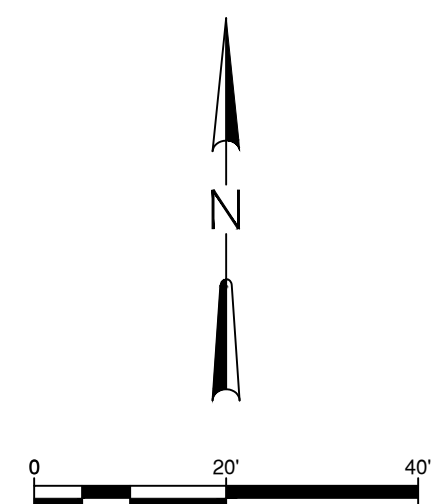

PRELIMINARY NOT
FOR CONSTRUCTION

GALVESTON PEDESTRIAN IMPROVEMENTS
CITY PROJECT #1TGCI
ROADWAY PLAN
DESCHUTES COUNTY, OREGON



ENGINEERING

REVISIONS:

CITY OF BEND
ENGINEERING
710 NW WALL ST
BEND, OR 97701
541-330-4000

DESIGNED BY: DSE
DRAWN BY: DSE
SCALE: PER PLANS
FILE:
DATE: 11/04/2025

VERIFY SCALES
0 1"
BAR EQUALS ONE INCH
ON ORIGINAL DRAWING

SHEET:

C2.6

COB # 1TGCI

Plotted: 11/4/25 at 2:02pm By: dalmore

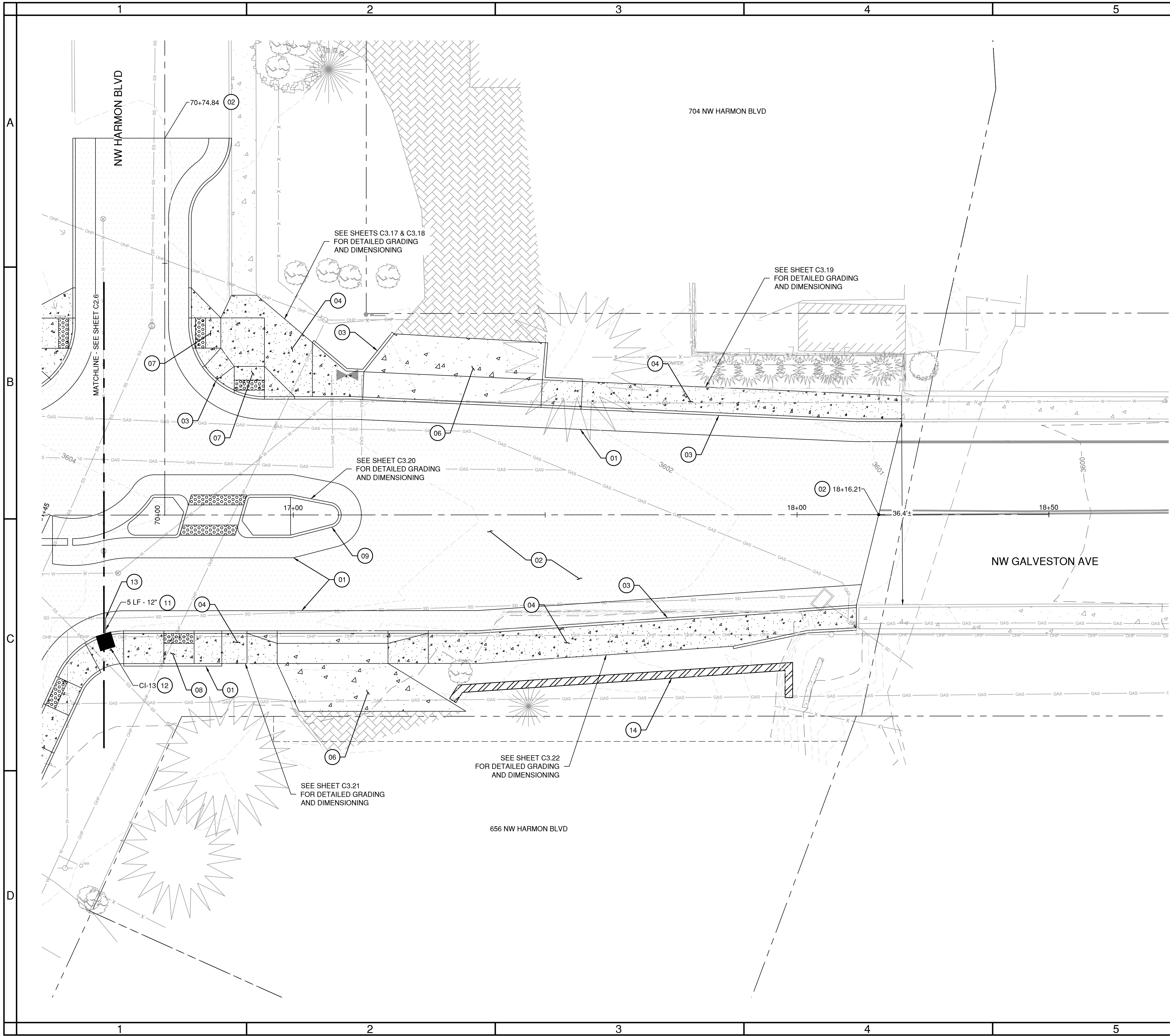

SHEET NOTES

- SEE SHEETS G1.0 & G1.1 FOR LEGEND INFORMATION AND ADDITIONAL NOTES.
- SEE SHEET C5.0 FOR PROPOSED TYPICAL ROAD SECTION INFORMATION.
- SEE CITY OF BEND STANDARD DRAWINGS R-4A AND R-4B ON SHEET C5.1 FOR SIDEWALK PAVEMENT JOINTING.
- CONTRACTOR TO PROTECT ALL ITEMS ON ADJACENT PROPERTIES AND IN THE RIGHT OF WAY NOT NOTED OTHERWISE. CONTRACTOR SHALL BE RESPONSIBLE FOR RESTORING ANY DAMAGED ITEMS TO ORIGINAL CONDITION.
- CONTRACTOR TO PROTECT ALL PAVEMENT MARKINGS NOT NOTED FOR REMOVAL. IF ANY PAVEMENT MARKING ARE DAMAGED IT IS THE CONTRACTORS RESPONSIBILITY TO REPLACE TO CURRENT OR BETTER CONDITIONS.
- LANDINGS ON ACCESSIBLE ROUTES SHALL NOT EXCEED 2% IN ANY DIRECTION. ALL ACCESSIBLE ROUTES SHALL COMPLY WITH CURRENT ADA ACCESSIBILITY GUIDELINES.
- PIPE BEDDING AND BACKFILL FOR ALL UTILITIES SHALL BE COMPLETED PER CITY OF BEND STANDARDS, SEE CITY OF BEND STANDARD DRAWING R-10 ON SHEET C5.2. IF TRENCHING OCCURS OUTSIDE OF THE PROPOSED ROADWAY RECONSTRUCTION RESTORATION SHALL BE COMPLETED PER CITY OF BEND STANDARDS, SEE CITY OF BEND STANDARD DRAWING R-11 ON SHEET C5.2.
- STRUCTURE LOCATIONS ARE BASED ON CENTER OF STRUCTURE.

CONSTRUCTION NOTES

- INSTALL ASPHALT SURFACING AND BASE, SEE CITY OF BEND STANDARD DRAWING R-1 ON SHEET C5.0
- INSTALL 2" GRIND AND INLAY OF EXISTING ASPHALT SURFACING MATCHING EXISTING GRADE, SEE CITY OF BEND STANDARD DRAWINGS R-1, R-1A AND R-1E ON SHEET C5.0
- INSTALL STANDARD CONCRETE CURB, SEE CITY OF BEND STANDARD DRAWINGS R-3 AND R-3A ON SHEET C5.0
- INSTALL CONCRETE SIDEWALK, SEE CITY OF BEND STANDARD DRAWINGS R-4A AND R-4B ON SHEET C5.1
- NOT USED
- INSTALL CONCRETE DRIVEWAY, SEE CITY OF BEND STANDARD DRAWING R-5A ON SHEET C5.1
- INSTALL CURB RAMP AND DETECTIBLE WARNING, SEE CITY OF BEND STANDARD DRAWINGS R-6, R-6A AND R-6C ON SHEET C5.1
- INSTALL CURB RAMP AND DETECTIBLE WARNING, SEE CITY OF BEND STANDARD DRAWINGS R-6, R-6B AND R-6C ON SHEET C5.1
- INSTALL MEDIAN / ISLAND, SEE CITY OF BEND STANDARD DRAWING R-25 ON SHEET C5.2
- NOT USED
- INSTALL PVC D3034 GRAVITY STORM MAIN, SIZE PER PLANS, SEE CITY OF BEND STANDARD DRAWING S-1 ON SHEET C5.2
- INSTALL STANDARD CURB INLET, SEE CITY OF BEND STANDARD DRAWING STRM-9 ON SHEET C5.2
- CONNECT TO EXISTING MAIN, FIELD VERIFY LOCATION AND IE OF EXISTING STORM MAIN PRIOR TO CONSTRUCTION
- INSTALL LANDSCAPE RETAINING WALL

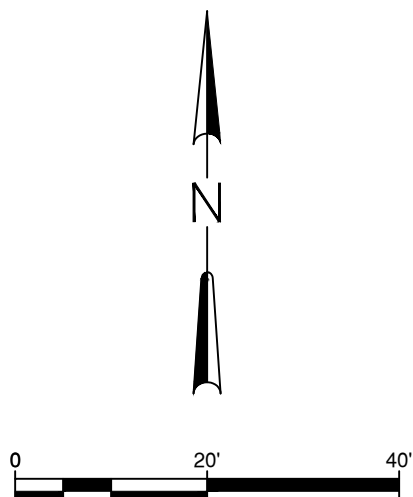

PRELIMINARY NOT
FOR CONSTRUCTION

GALVESTON PEDESTRIAN IMPROVEMENTS
CITY PROJECT #1TGCI
ROADWAY PLAN
DESCHUTES COUNTY, OREGON



ENGINEERING

REVISIONS:

CITY OF BEND
ENGINEERING
710 NW WALL ST
BEND, OR 97701
541-330-4000

DESIGNED BY: DSE
DRAWN BY: DSE
SCALE: PER PLANS
FILE:
DATE: 11/04/2025

VERIFY SCALES
0 1"
BAR EQUALS ONE INCH
ON ORIGINAL DRAWING

SHEET:

C2.7

COB # 1TGCI

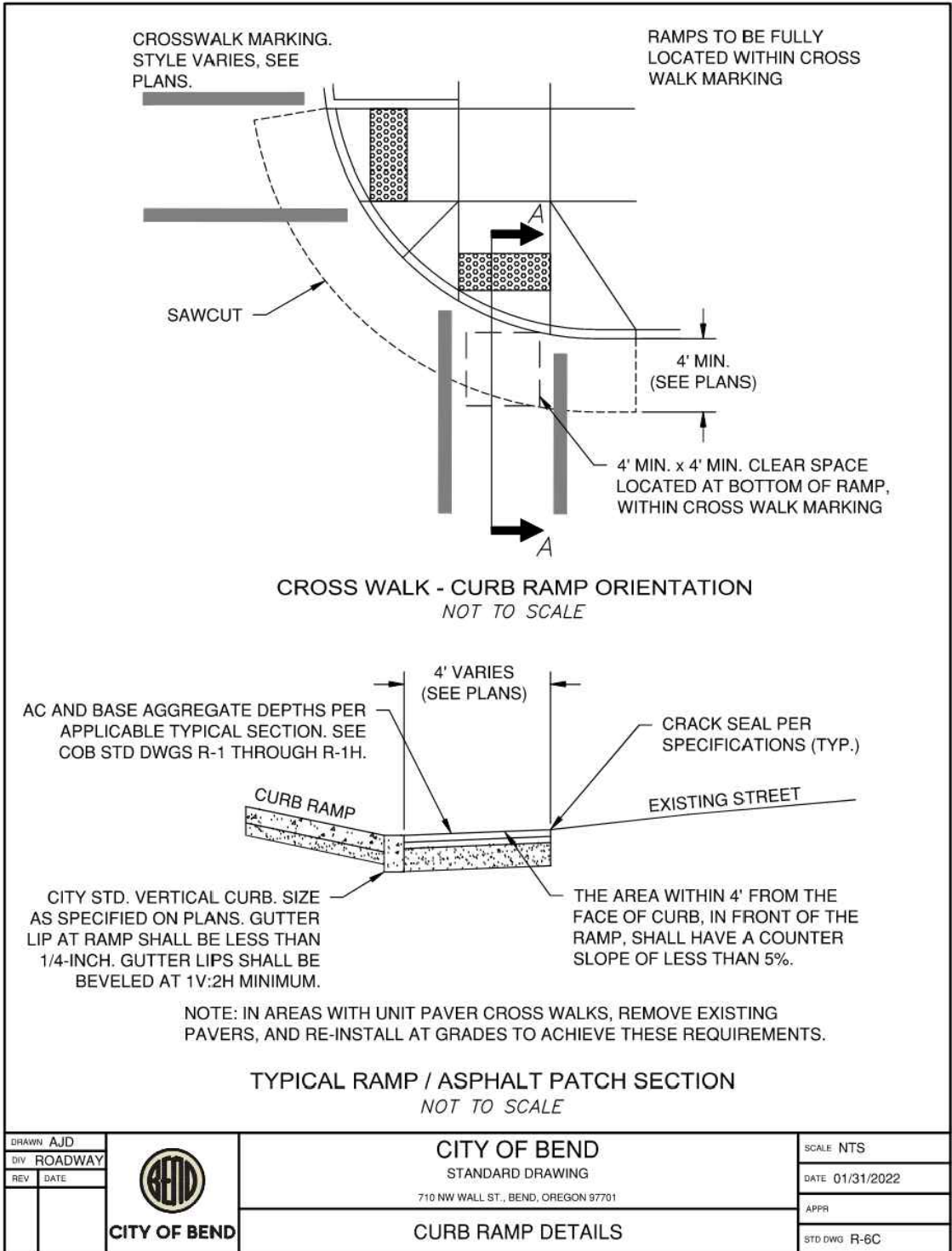
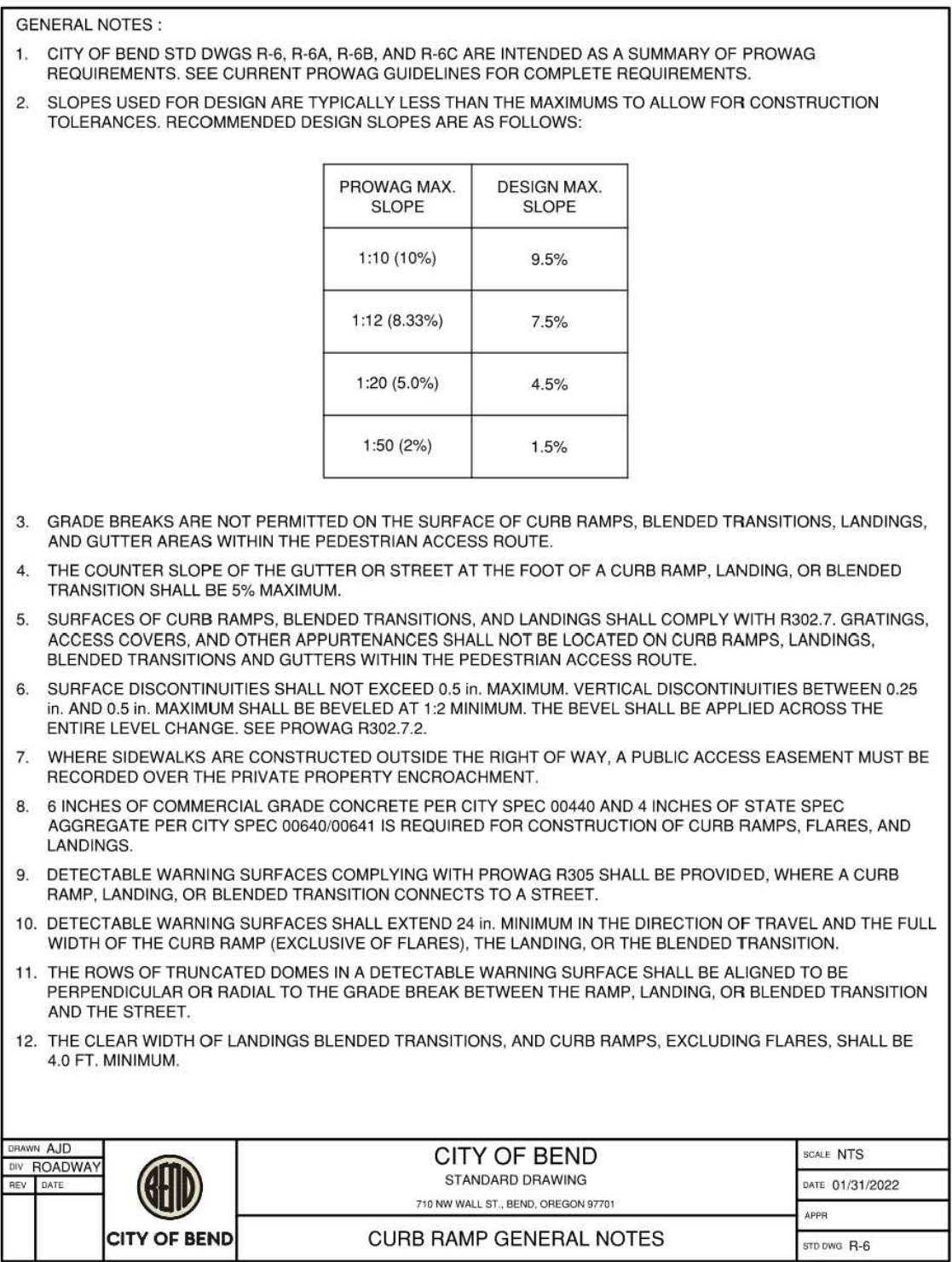

SHEET:
C5.1
COB # 1TGCI

Plotted: 11/14/25 at 2:08pm By: dalmore

1		2		3		4		5		6																																																																									
<table><tr><td colspan="12">A</td></tr><tr><td colspan="12">B</td></tr><tr><td colspan="12">C</td></tr><tr><td colspan="12">D</td></tr></table>												A												B												C												D																																			
A																																																																																			
B																																																																																			
C																																																																																			
D																																																																																			
<table><tr><td colspan="12">A</td></tr><tr><td colspan="12">B</td></tr><tr><td colspan="12">C</td></tr><tr><td colspan="12">D</td></tr></table>												A												B												C												D																																			
A																																																																																			
B																																																																																			
C																																																																																			
D																																																																																			
<table><tr><td colspan="12">1</td></tr><tr><td colspan="12">2</td></tr><tr><td colspan="12">3</td></tr><tr><td colspan="12">4</td></tr><tr><td colspan="12">5</td></tr><tr><td colspan="12">6</td></tr></table>												1												2												3												4												5												6											
1																																																																																			
2																																																																																			
3																																																																																			
4																																																																																			
5																																																																																			
6																																																																																			

<div>PRELIMINARY NOT FOR CONSTRUCTION</div> <div>GALVESTON PEDESTRIAN IMPROVEMENTS</div> <div>CITY PROJECT #1TGCI</div> <div>STANDARD COB DETAILS</div> <div>DESCHUTES COUNTY, OREGON</div>											
<div>ENGINEERING</div> <div>REVISIONS:</div> <div><div>CITY OF BEND ENGINEERING</div><div>710 NW WALL ST BEND, OR 97701 541-330-4000</div><div>DESIGNED BY: DSE DRAWN BY: DSE SCALE: PER PLANS FILE: DATE: 11/04/2025</div></div>											
<div>VERIFY SCALES</div> <div>0 1"</div> <div>BAR EQUALS ONE INCH ON ORIGINAL DRAWING</div> <div>SHEET: C5.3</div> <div>COB # 1TGCI</div>											

<table><tr><td colspan="2">CITY OF BEND STANDARD DRAWING 710 NW WALL ST., BEND, OREGON 97701 PAVEMENT MARKINGS - WHITE</td><td colspan="2">SCALE: NTS DATE: 01/31/2022 APP: R10 DMD: R-40</td></tr></table>												CITY OF BEND STANDARD DRAWING 710 NW WALL ST., BEND, OREGON 97701 PAVEMENT MARKINGS - WHITE		SCALE: NTS DATE: 01/31/2022 APP: R10 DMD: R-40		<table><tr><td colspan="2">CITY OF BEND STANDARD DRAWING 710 NW WALL ST., BEND, OREGON 97701 PAVEMENT MARKINGS - YELLOW</td><td colspan="2">SCALE: NTS DATE: 01/31/2022 APP: R10 DMD: R-41</td></tr></table>												CITY OF BEND STANDARD DRAWING 710 NW WALL ST., BEND, OREGON 97701 PAVEMENT MARKINGS - YELLOW		SCALE: NTS DATE: 01/31/2022 APP: R10 DMD: R-41	
CITY OF BEND STANDARD DRAWING 710 NW WALL ST., BEND, OREGON 97701 PAVEMENT MARKINGS - WHITE		SCALE: NTS DATE: 01/31/2022 APP: R10 DMD: R-40																													
CITY OF BEND STANDARD DRAWING 710 NW WALL ST., BEND, OREGON 97701 PAVEMENT MARKINGS - YELLOW		SCALE: NTS DATE: 01/31/2022 APP: R10 DMD: R-41																													

<table><tr><td colspan="2">CITY OF BEND STANDARD DRAWING 710 NW WALL ST., BEND, OREGON 97701 PAVEMENT MARKINGS</td><td colspan="2">SCALE: NTS DATE: 01/31/2022 APP: R10 DMD: R-42A</td></tr></table>												CITY OF BEND STANDARD DRAWING 710 NW WALL ST., BEND, OREGON 97701 PAVEMENT MARKINGS		SCALE: NTS DATE: 01/31/2022 APP: R10 DMD: R-42A		<table><tr><td colspan="2">CITY OF BEND STANDARD DRAWING 710 NW WALL ST., BEND, OREGON 97701 PAVEMENT MARKINGS</td><td colspan="2">SCALE: NTS DATE: 01/31/2022 APP: R10 DMD: R-42B</td></tr></table>												CITY OF BEND STANDARD DRAWING 710 NW WALL ST., BEND, OREGON 97701 PAVEMENT MARKINGS		SCALE: NTS DATE: 01/31/2022 APP: R10 DMD: R-42B	
CITY OF BEND STANDARD DRAWING 710 NW WALL ST., BEND, OREGON 97701 PAVEMENT MARKINGS		SCALE: NTS DATE: 01/31/2022 APP: R10 DMD: R-42A																													
CITY OF BEND STANDARD DRAWING 710 NW WALL ST., BEND, OREGON 97701 PAVEMENT MARKINGS		SCALE: NTS DATE: 01/31/2022 APP: R10 DMD: R-42B																													

<table><tr><td colspan="2">CITY OF BEND STANDARD DRAWING 710 NW WALL ST., BEND, OREGON 97701 PAVEMENT MARKINGS - BIKE</td><td colspan="2">SCALE: NTS DATE: 11/01/2024 APP: R10 DMD: R-43</td></tr></table>												CITY OF BEND STANDARD DRAWING 710 NW WALL ST., BEND, OREGON 97701 PAVEMENT MARKINGS - BIKE		SCALE: NTS DATE: 11/01/2024 APP: R10 DMD: R-43	
CITY OF BEND STANDARD DRAWING 710 NW WALL ST., BEND, OREGON 97701 PAVEMENT MARKINGS - BIKE		SCALE: NTS DATE: 11/01/2024 APP: R10 DMD: R-43													

PRELIMINARY NOT
FOR CONSTRUCTION

GALVESTON PEDESTRIAN IMPROVEMENTS
CITY PROJECT #1TGCI
STANDARD COB DETAILS
DESCHUTES COUNTY, OREGON



REVISIONS:

CITY OF BEND
ENGINEERING
710 NW WALL ST
BEND, OR 97701
541-330-4000

DESIGNED BY: DSE
DRAWN BY: DSE
SCALE: PER PLANS
FILE:
DATE: 11/04/2025

VERIFY SCALES
0 1"
BAR EQUALS ONE INCH
ON ORIGINAL DRAWING

SHEET:
C5.3

COB # 1TGCI

 4" WHITE LINE	 8" WHITE LINE
 4" WHITE BROKEN LINE	 8" WHITE DOTTED LANE LINE
 4" WHITE DOTTED LINE For lane extensions	 8" WHITE DOTTED LINE For lane extensions
 8" WHITE DOTTED ROUNDABOUT CIRCULATING LINE INSTALL AS TYPE B-HS PREFORMED THERMOPLASTIC	 NARROW DOUBLE NO-LANE CHANGE TWO 4" WHITE LINES
<div><div><div><div></div><div></div></div><div><div></div><div></div></div></div><div><div><div></div><div></div></div><div><div></div><div></div></div></div></div> <div>CITY OF BEND STANDARD DRAWING 710 NW WALL ST., BEND, OREGON 97701 DATE: 01/31/2022 SCALE: NTS APP: R-40</div>	<div><div><div><div></div><div></div></div><div><div></div><div></div></div></div><div><div><div></div><div></div></div><div><div></div><div></div></div></div></div> <div>CITY OF BEND STANDARD DRAWING 710 NW WALL ST., BEND, OREGON 97701 DATE: 01/31/2022 SCALE: NTS APP: R-40</div>

 4" YELLOW LINE	 4" YELLOW BROKEN LINE
 4" YELLOW DOTTED LINE For lane extensions	 DOUBLE NO-PASS TWO 4" YELLOW LINES
 NARROW DOUBLE NO-PASS TWO 4" YELLOW LINES	 NO-PASS RIGHT 4" YELLOW LINES
 NO-PASS LEFT 4" YELLOW LINES	 TWO-WAY LEFT TURN 4" YELLOW LINES SEE R-44 FOR ARROW PLACEMENT
<div><div><div><div></div><div></div></div><div><div></div><div></div></div></div><div><div><div></div><div></div></div><div><div></div><div></div></div></div></div> <div>CITY OF BEND STANDARD DRAWING 710 NW WALL ST., BEND, OREGON 97701 DATE: 01/31/2022 SCALE: NTS APP: R-41</div>	<div><div><div><div></div><div></div></div><div><div></div><div></div></div></div><div><div><div></div><div></div></div><div><div></div><div></div></div></div></div> <div>CITY OF BEND STANDARD DRAWING 710 NW WALL ST., BEND, OREGON 97701 DATE: 01/31/2022 SCALE: NTS APP: R-41</div>

 STANDARD CROSSWALK TWO 1" WHITE BARS	 STOP BAR 1" WHITE BAR
 STAGGERED CONTINENTAL CROSSWALK 2" WHITE BARS	 TRANSVERSE SHOULDER BARS 1" WHITE BARS AT 20" SPACING
 TRANSVERSE MEDIAN BARS 1" YELLOW BARS AT 20" SPACING	 2" BUFFER BETWEEN BIKE LANE AND PARKING BUFFER STRIPE
 PARKING PROTECTED BIKE LANE	
<div><div><div><div></div><div></div></div><div><div></div><div></div></div></div><div><div><div></div><div></div></div><div><div></div><div></div></div></div></div> <div>CITY OF BEND STANDARD DRAWING 710 NW WALL ST., BEND, OREGON 97701 DATE: 01/31/2022 SCALE: NTS APP: R-42A</div>	<div><div><div><div></div><div></div></div><div><div></div><div></div></div></div><div><div><div></div><div></div></div><div><div></div><div></div></div></div></div> <div>CITY OF BEND STANDARD DRAWING 710 NW WALL ST., BEND, OREGON 97701 DATE: 01/31/2022 SCALE: NTS APP: R-42A</div>

 ONLY (white)	 SCHOOL (white)
 ELONGATED STRAIGHT ARROW (white)	 ELONGATED TURN ARROW (white)
 ELONGATED LEFT TURN STRAIGHT ARROW (white)	 ELONGATED RIGHT TURN STRAIGHT ARROW (white)
 ON-STREET PARKING DETAIL (white)	 SPEED BUMP MARKING (WHITE)
<div><div><div><div></div><div></div></div><div><div></div><div></div></div></div><div><div><div></div><div></div></div><div><div></div><div></div></div></div></div> <div>CITY OF BEND STANDARD DRAWING 710 NW WALL ST., BEND, OREGON 97701 DATE: 01/31/2022 SCALE: NTS APP: R-42B</div>	<div><div><div><div></div><div></div></div><div><div></div><div></div></div></div><div><div><div></div><div></div></div><div><div></div><div></div></div></div></div> <div>CITY OF BEND STANDARD DRAWING 710 NW WALL ST., BEND, OREGON 97701 DATE: 01/31/2022 SCALE: NTS APP: R-42B</div>

 BIKE LANE STANDARD STENCIL (white)	 BIKE SYMBOL (WHITE)
 BIKE RIGHT TURN STENCIL (white)	 BIKE LEFT TURN STENCIL (white)
 BIKE RIGHT TURN STRAIGHT STENCIL (white)	 BIKE LEFT TURN STRAIGHT STENCIL (white)
 BIKE DETECTOR (WHITE)	 BIKE LANE STANDARD STENCIL (white with green background)
<div><div><div><div></div><div></div></div><div><div></div><div></div></div></div><div><div><div></div><div></div></div><div><div></div><div></div></div></div></div> <div>CITY OF BEND STANDARD DRAWING 710 NW WALL ST., BEND, OREGON 97701 DATE: 11/01/2024 SCALE: NTS APP: R-43</div>	<div><div><div><div></div><div></div></div><div><div></div><div></div></div></div><div><div><div></div><div></div></div><div><div></div><div></div></div></div></div> <div>CITY OF BEND STANDARD DRAWING 710 NW WALL ST., BEND, OREGON 97701 DATE: 11/01/2024 SCALE: NTS APP: R-43</div>